

# AMR

PUISSANCE & PERFORMANCES

## PRODUCT CATALOGUE

 EN 2017



[www.a-m-r.fr](http://www.a-m-r.fr)



FORESTRY & FARMING  
**EQUIPMENT MANUFACTURER**  
SINCE 1984

**AMR, FORESTRY & FARMING  
EQUIPMENT MANUFACTURER  
SINCE 1984**



Since our company was formed in Alsace in 1984, we have been designing and producing machines for firewood production and farming equipment. First and foremost we are a team based on our own recognised expertise and skills. Our main goal: customer satisfaction.

Thanks to our manufacturing process controls we build reliable machines to ensure comfort and safety for the user. Our machines are sold throughout France by 450 specialised dealers and in Europe with the brand Vogesenblitz ("Vosges Mountains lightning").

We hold and attend many events: shows, fairs and open days in France and Europe to introduce our new products to you.



**A 50 PEOPLE TEAM AT YOUR SERVICE**

# MANUFACTURER IS OUR JOB

Around 4500 machines are designed and manufactured in our Alsatian 9200 m<sup>2</sup> plant. We are proud of making in France quality machines to provide our customers with reliable and efficient products.

From design to assembly, here is the process :



## DESIGN - DESIGN OFFICE

To imagine, develop, optimise and design our machines is the role of the Design Office. Our inspiration comes from our customers.

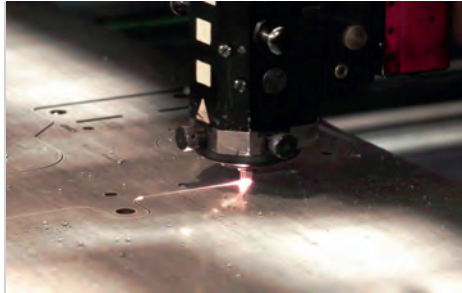

## MANUFACTURING - LASER

Parts up to 15mm thick are cut from metal sheets by our laser-cutter.

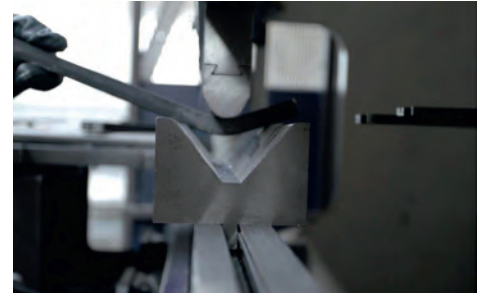

## MANUFACTURING - FOLDING

Parts up to 3000mm wide are folded by our CNC (Computer Numerical Control) machine.



## MANUFACTURING - BENDING

Our bending machine is programmed according to the pipe's dimensions. The material elasticity allows complex yet accurate bending.



## MANUFACTURING - WELDING

According to the type of welding, fabrication is manual or automated.



## MANUFACTURING - PAINTING

When the parts are ready they are powder-coated then baked to harden the paint and make it look bright.



## MANUFACTURING - ASSEMBLY

The final step is here to assemble all parts!



## SUBCONTRACTING - KUHN

Since our creation we offer industrial outsourcing services. Our know-how and experience make us able to meet the requirements for quality, price and deadlines.

One of our oldest customers (33 years) is Kuhn based in Saverne, Alsace.



## SUBCONTRACTING - JMEKA

The JMEKA mini diggers are also manufactured in the AMR factory.

More information on [www.jmeka.fr](http://www.jmeka.fr)



# HISTORY

**AMR's site is based in Elsenheim in Alsace and bears witness to a rich and varied industrial past.**

Its history began at the end of the 19th century when a German company constructed the building to set up a cigar factory there. The facility was bought up in the 1950s and became a weaving company.

There was another change six years later when the Lower-Rhine agricultural machine manufacturing company «Heywang» moved in. In 1984 «Heywang» moved out again and the company was taken over by some of its employees...

**1984** →



Take-over of the factory by some employees who started making forestry winches and log splitters

**2005** →



The firm was bought by Robert Heissler who gave it the name AMR.



The «Ateliers Mécaniques du Ried» company was created.

Through his impetus, AMR devoted its energies and know-how to develop machines for firewood production

Marketing of the new QUATROMAT semi-automatic saw.



**2012**

After 1 year research and patents, the saw was a resounding success with professionals in the timber industry.



Great year for AMR which celebrated its 30th anniversary!



**2014**



AMR is staying on track by maintaining a policy of development and innovation on a day-to-day basis.

**2015** →



**AMR company changes hands!**

Gert Unterreiner, the German leader in the distribution of forestry equipment take the opportunity to make his first steps as manufacturer.





**2016** →



AMR's products have been awarded with a lot of innovation and safety trophies.



# SUMMARY

<b>6 - 45</b>	<b>SPLITTING RANGE</b>
7-16	Log splitter 50 cm
17-44	Log splitter 100 cm and more
45	Kindling machine
<b>46 - 67</b>	<b>SAWING RANGE</b>
48 - 57	Professional saw  
58 - 67	Tilting saw, table saw, band-saw and conveyor
<b>68 - 74</b>	<b>SKIDDING RANGE</b>
69 - 71	Skidding grapple
72 - 74	Radio remote control
<b>75 - 82</b>	<b>HANDLING RANGE</b>
76 - 80	Grapple and bundler
81 - 82	Timber claw, timber blade and rotator
<b>83 - 87</b>	<b>FARMING RANGE</b>
84	Universal bucket
85 - 87	Stone fork - Forest Mulcher
<b>88 - 94</b>	<b>ACCESSORIES</b>

> Conditions and warranty (see page 99).

# SPLITTING RANGE



## Vertical splitter 6 Tons - Hobby series

### ■ Hobby Series

Fits perfectly for individuals who primarily use logs up to 52 cm (and up to 1 m occasionally).

Easy to use and move.

- 2-handed control
- Protected handles system
- Wheels for transport
- 2 table positions 52/105 cm
- Integrated phase inverter (400V motor)
- High return speed
- Split-wedge
- Adjustable cylinder stroke up to 50 cm



Ø 35 cm  
< 50/100 cm >



*HOBBY-6-M  
Table in position 52 cm*



*HOBBY-6-M  
Table in position 105 cm*

Log splitter	HOBBY-6-M	HOBBY-6-T
Tons (to)	6	6
Cutting length (cm)	105	105
Power supply	single-phased 2.2 kW 230 V	three-phase 3 kW 400 V
Splitting speed / return speed (cm/s)	4 - 17	4 - 17
Oil capacity (L)	7	7
Pump output (L/min)	7	7
Dimension (HxLxW cm)	109 x 71 x 54	109 x 71 x 54
Table position (cm)	52 / 105	52 / 105
Weight (kg)	114	114
Cross splitter Hobby (Ref. FCX HOBBY)		
400 V female plug (Ref. PRI F16)		

### ■ FB500 Series, 6 tons

The FB500 is even more robust and more comfortable. Depending on the model, you can adjust the cutting height (table position : fixed 55 cm / 2 levels 55-105 cm / 3 levels: 55 -75 -105 cm) according to your logs.

- Safety : 2-handed control
- Wheels for transport
- Integrated phase inverter (400V motor)
- High speed return
- Robust and durable design
- Adjustable cylinder stroke up to 50cm



Ø 35 cm  
< 50-75-100cm >

FB500/G4 - 6 To  
Fixed table



FB500/E2 - 6 To  
3-position table

Log splitter	FB500/G4 M	FB500/G4 T	FB500/E2 M	FB500/E2 T
Tons (to)	6	6	6	6
Cutting length (cm)	55	55	105	105
Power supply	single-phased 230 V 2.2 kW	three-phase 400 V 2.2 kW	single-phased 230 V 2.2 kW	three-phase 400 V 2.2 kW
Splitting speed (cm/s)	5	5	5	5
Return speed (cm/s)	16.7	16.7	16.7	16.7
Oil capacity (L)	4.75	4.75	4.75	4.75
Pump output (L/min)	7.5	9	7.5	9
Table position(cm)	Fixe 55	Fixe 55	55-75-105	55-75-105
Dimension (HxLxW cm)	112 x 50 x 80	112 x 50 x 80	112 x 50 x 80	112 x 50 x 80
Weight (kg)	110	110	110	110
Cross splitter 6/7 (Ref. FCX 6/7)				
Split-wedge 6/7 (Ref. ECL 6/7)				
400 V female plug (Ref. PRI F16)				



## Vertical splitter 7 Tons - FB500 series

### ■ FB500 Series, 7 tons

The FB500 is even more robust and more comfortable. Depending on the model, you can adjust the cutting height (table position : fixed 55 cm / 2 levels 55-105 cm / 3 levels 55 - 75 - 105 cm) according to your logs.

- Safety : 2-handed control
- Wheels for transport
- Integrated phase inverter (400 V motor)
- High speed return
- Oil filter
- Robust and durable design
- Adjustable cylinder stroke up to 50cm



∅ 35 cm  
< 50-75-100cm >

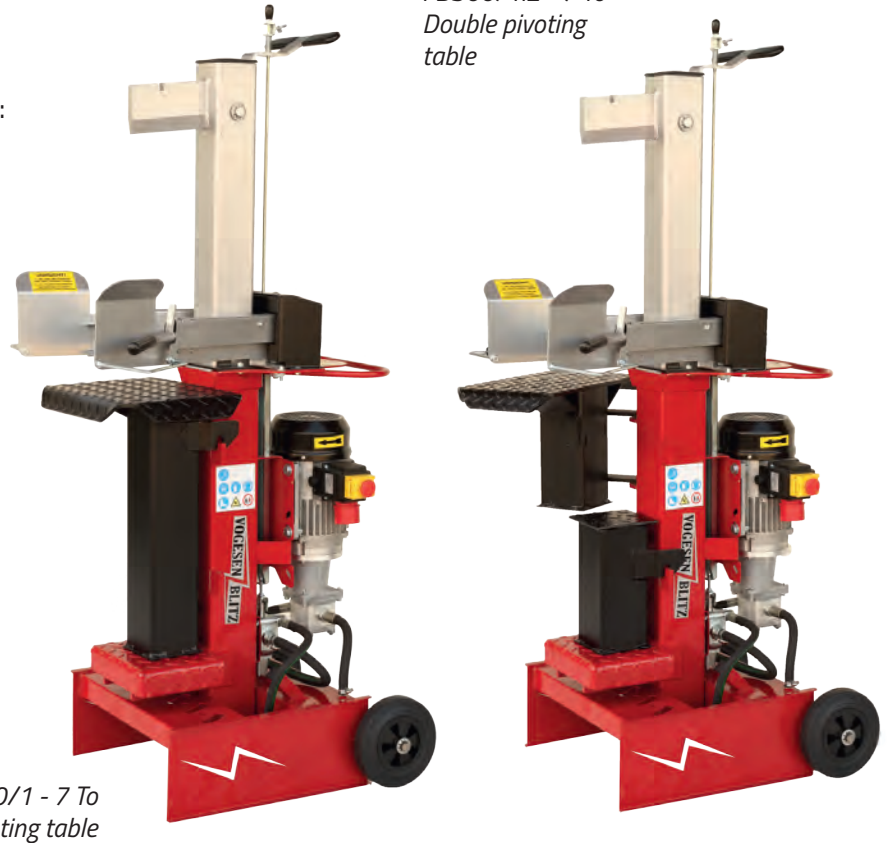

FB500/1 - 7 To  
Pivoting table

FB500/1.2 - 7 To  
Double pivoting  
table

Log splitter	FB500/1 M	FB500/1 T	FB500/1.2 M	FB500/1.2 T
Tons (to)	7	7	7	7
Cutting length (cm)	105	105	105	105
Power supply	single-phased 230 V 2.2 kW	three-phase 400 V 2.2 kW	single-phased 230 V 2.2 kW	three-phase 400 V 2.2 kW
Splitting speed (cm/s)	4.8	4.8	4.8	4.8
Return speed (cm/s)	12.5	12.5	12.5	12.5
Oil capacity (L)	10	10	10	10
Pump output (L/min)	7.5	9	7.5	9
Table position (cm)	55-105	55-105	55-75-105	55-75-105
Dimension (HxLxW cm)	112 x 60 x 80	112 x 60 x 80	112 x 60 x 80	112 x 60 x 80
Weight (kg)	135	135	138	138

Driven with Power Take-Off (PTO), gasoline or combined. Model FB500/05 with fixed table 55 cm. CONTACT US

Cross splitter 6/7 (Ref. FCX 6/7)

Split-wedge 6/7 (Ref. ECL 6/7)

400 V female plug (Ref. PRI F16)

### ■ FB509CR Series

The most professional of short splitters, with reinforced frame and removable table with a removable basket. With its 9 Tons power, it is suitable for logs from 50 to 100 cm.

- Safety : 2-handed control with synchronized handles
- High speed return
- Wheels for transport
- Integrated phase inverter (400 V motor)
- Wide floor plate in full steel
- Oil filter
- Automatic knife return
- Robust and durable design
- Adjustable cylinder up to 50 cm
- Specific options: knife extension 105 cm and pivoting table



Ø 40 cm  
< 50/100 cm >

*FB509CR  
with options  
pivoting table and  
knife extension*



Log splitter	FB509CR M	FB509CR T	FB509CR PDF	FB509CR ESS
Tons (to)	9	9	9	9
Cutting length (cm)	55 (option 105)	55 (option 105)	55 (option 105)	55 (option 105)
Pump	double	single	single	double
Power supply	single-phased 230 V 2.2 kW	three-phase 400 V 3 kW	PTO tractor	petrol Honda 5.5 HP
Splitting speed (cm/s)	8.2	5.6	5.7	8.7
Return speed (cm/s)	9.4	12.5	15.2	12.5
Oil capacity (L)	10	10	10	10
Pump output (L/min)	19	13.5	14.7	19
Dimension (HxLxW cm)	130 x 60 x 84	130 x 60 x 84	130 x 60 x 107	130 x 60 x 109
Weight (kg)	210	210	210	215

Combined driving.  
CONTACT US

Cross splitter FB509 (Ref. FCX FB509)

Split-wedge FB509 (Ref. ECL FB509)

Knife extension 105 cm *for FB509CR* (Ref. RAL FB509CR)

Pivoting table *for FB509CR* (Ref. BOT FB509CR)

400 V female plug (Ref. PRI F16)

## Vertical splitter 9 Tons - FB509TF series

### ■ FB509TF Series

This 9 Tons splitter has two disposal baskets, a fixed table and a 55 cm opening. Safety norm EN609-1.

- Safety : 2-handed control with synchronized handles
- Wheels for transport
- Integrated phase inverter (400 V motor)
- Wide floor plate in full steel
- 2 removable baskets
- Oil filter
- Robust and durable design
- Fixed table
- 50 cm cylinder stroke



Synchronized handholds (patented)

Video on  
[www.a-m-r.fr](http://www.a-m-r.fr)



FB509TF with fixed table and 2 removable baskets



Ø 40 cm  
< 50 cm >



Log splitter	FB509TF M	FB509TF T	FB509TF PDF	FB509TF ESS
Tons (to)	9	9	9	9
Cutting length (cm)	55	55	55	55
Pump	double	single	single	double
Power supply	single-phased 230 V 2.2 kW	three-phase 400 V 4 kW	PTO tractor	petrol Honda 5.5 HP
Splitting speed (cm/s)	8.2	6.8	5.7	8.7
Return speed (cm/s)	9.4	15.2	15.2	12.5
Oil capacity (L)	10	10	10	10
Pump output (L/min)	19	16.5	14.7	19
Dimension (HxLxW cm)	130 x 60 x 84	130 x 60 x 84	130 x 60 x 107	130 x 60 x 109
Weight (kg)	190	190	190	205

Combined driving.  
CONTACT US

Cross splitter FB509 (Ref. FCX FB509)

Split-wedge FB509 (Ref. ECL FB509)

400 V female plug (Ref. PRI F16)

### ■ H09 series

The smallest horizontal splitter with a 9 Tons power.

- Power : 9 Tons with two splitting speeds
- Safety : 2-handed control
- Robust and durable design : welded frame
- Wheels for transport
- Oil filter
- Integrated phase inverter (400 V motor)
- High speed return
- Safety : engine rotating direction detector
- Brass slide rails

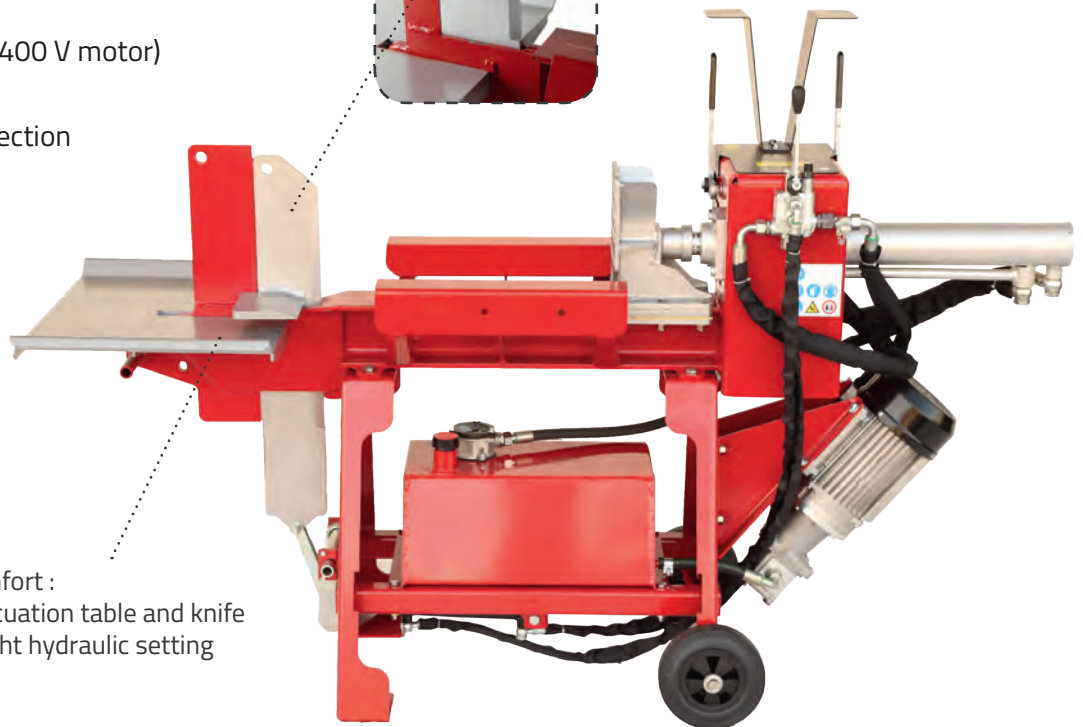

Comfort :  
Evacuation table and knife  
height hydraulic setting



Ø 35 cm  
< 50 cm >

Log splitter	HEL09 M	HEL09 T
Tons (to)	9	9
Cutting length (cm)	55	55
Pump	double	single
Power supply	single-phased 230 V 2,2 kW	three-phase 400 V 4 kW
Splitting speed 1 (cm/s)	6.6	6.4
Splitting speed 2 (cm/s)	14.8	14.7
Return speed (cm/s)	11.2	10.2
Oil capacity (L)	20	20
Pump output (L/min)	16	16.5
Dimension (HxLxW cm)	135 x 212 x 78	135 x 212 x 78
Weight (kg)	235	235
Hydraulic, PTO or combined driving. CONTACT US	3-points tractor hitch for HEL09 (Ref. ATT HEL09)	

## Horizontal splitter 9 Tons - H09S series

### ■ H09S series

New semi-automatic splitter adapted to new European safety norm EN 609-1.

- Power : 9 Tons with automatic splitting speeds
- Safety : light pivoting hood easy to manipulate. The cylinder stops when the hood is open.
- Comfort : Inclined evacuation table and knife height hydraulic setting
- Robust and durable design : welded frame
- Wheels for transport
- Oil filter
- Integrated phase inverter (400 V motor)
- High speed return
- Security : engine rotating direction detector (400 V motor)

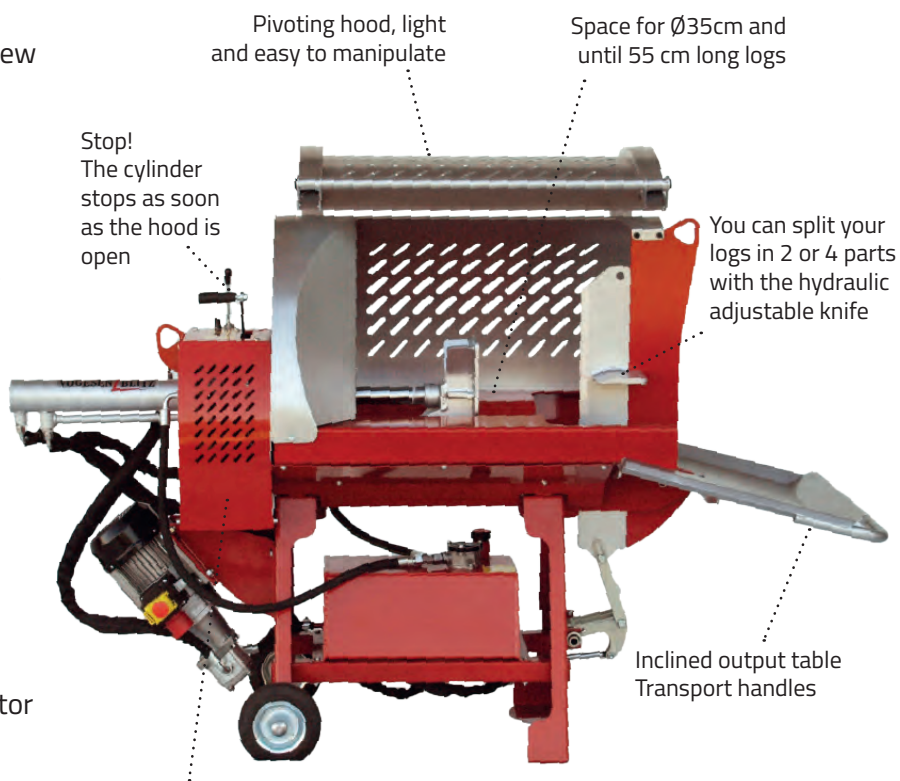

New semi-automatic control system :  
1 pulse = 1 whole cycle. Free hands!  
The cylinder has 2 automatic speeds.



Ø 35 cm  
< 50 cm >

Hydraulic, PTO  
or combined  
driving.  
CONTACT US

Log splitter	HEL09S M	HEL09S T
Tons (to)	9	9
Cutting length (cm)	55	55
Pump	double	single
Power supply	single-phased 230 V 2.2 kW	three-phase 400 V 4 kW
Speed 1 and 2 (cm/s)	auto speed 16	auto speed 16.2
Return speed (cm/s)	12.5	11.6
Oil capacity (L)	20	20
Pump output (L/min)	16	16,5
Dimension (HxLxW cm)	135 x 212 x 78	135 x 212 x 78
Weight (kg)	337	337

### ■ VEL5507

7 Tons power and 2 speeds for splitting easily logs until 60 cm long. Comfortable with the 230V electrical supply, and easy moving with inflatable wheels and automatic log-grip system.

- Safety : 2-handed control
- Inflatable wheels for easy moving
- Log-grip system
- 62 cm opening
- Two splitting speeds
- Robust and durable design



Ø 35 cm  
< 60 cm >



VEL5507

Log splitter	VEL5507 M
Tons (to)	7
Cutting length (cm)	62
Power supply	single-phased 230 V 2.2 kW
Speed 1 / 2 (cm/s)	3.7 / 11
Return speed (cm/s)	6
Oil capacity (L)	7
Pump output (L/min)	7
Dimension (HxLxW cm)	160 x 65 x 80
Weight (kg)	139

# Horizontal/vertical splitter 9-12 Tons - HV series

## ■ HV series

A splitter model that can be used in vertical either horizontal position. Available in 9/12 Tons and with double speed.

- Safety : 2-handed control
- 62 cm opening
- Use in horizontal or vertical position
- Inflatable wheels for easy moving
- Trail support included (gasoline models)
- Integrated phase inverter (400 V motor)
- Robust and durable design : welded frame
- Floor plate in full steel
- Brass guiding system



Ø 40 cm  
< 60 cm >



*HVES12  
transport position*

*HVE9 M  
vertical position*



*HVE9 M  
horizontal position*

Log splitter	HVE09 MSP	HVE09 MDP	HVE09 T	HVES09	HVE12 MSP	HVE12 MDP	HVE12 T	HVES12
Tons (to)	9	9	9	9	12	12	12	12
Cutting length (cm)	62	62	62	62	62	62	62	62
Pump	single	double	single	double	single	double	single	double
Power supply	single-phased 230 V 2,2 kW	single-phased 230 V 2,2 kW	three-phase 400 V 3 kW	petrol Honda 5.5 HP	single-phased 230 V 2,2 kW	single-phased 230 V 2,2 kW	three-phase 400 V 4 kW	petrol Honda 5.5 HP
Speed 1 (cm/s)	3.2	6.62	5.6	8.13	2.51	4.23	4.2	5.6
Speed 2 (cm/s)	7.74	14.8	13	18.86	6.22	10.07	11.5	14.61
Return speed (cm/s)	5.1	11.2	9.8	13.7	4.02	7.2	6.8	9.82
Oil capacity (L)	13	13	13	13	13	13	13	13
Pump output	7.5 L/min	18.6 L/min	13.5 L/min	19 L/min	7.5 L/min	18.6 L/min	16.5 L/min	19 L/min
Dimension in vertical position (HxLxW cm)	162x76x100	162x76x100	162x76x100	162x76x230	162x76x100	162x76x100	162x76x100	162x76x230
Weight (kg)	200	200	200	220	205	205	205	225
Cross splitter (Ref. FCX V9-HV/V55)								
Trail support (Ref. TIMON HV09/12)								
400 V female plug (Ref. PRI F16)								

### ■ V5509/V5512 series

This vertical splitter is ideal for garden tractor, and available in PTO driving or hydraulic driving. Its power is 9 or 12 Tons and it has the double splitting speed.

- Safety: 2-handed control
- Inflatable wheels for easy moving
- 62 cm opening
- Two splitting speeds
- Robust and durable design: welded frame
- Floor plate in full steel
- Female gear box pump
- Brass guiding system
- 3-point hitch, cat. I and II



Ø 40 cm  
< 60 cm >



VPF5509

Log splitter	VHY5509	VPF5509	VHY5512	VPF5512
Tons (to)	9	9	12	12
Cutting length (cm)	62	62	62	62
Pump	-	Single	-	Single
Power supply	hydraulic tractor	PTO tractor	hydraulic tractor	PTO tractor
Speed 1 (cm/s)		9.1		7.8
Speed 2 (cm/s)	*	18.9	*	16.8
Return speed (cm/s)		13.5		13.1
Oil capacity (L)	*	13	*	13
Pump output (L/min)	*	14.7	*	14.7
Dimension (HxLxW cm)	162 x 76 x 100	162 x 76 x 100	162 x 76 x 100	162 x 76 x 100
Weight (kg)	185	195	190	200
Combined driving. CONTACT US	Cross splitter (Ref. FCX V9-HV/V55)			
	PTO plug (Ref. PR00061)			
	400 V female plug (Ref. PRI F16)			

\*Depending from tractor output



## Vertical splitter 9 Tons - V09 series

### ■ V09 series

A 109 cm opening for a 9 Tons power, with automatic log-grip arm. The whole machine is also easy to move with the inflatable wheels.

- Safety : 2-handed control
- 108 cm opening
- Retractable cylinder for storage
- Inflatable wheels for easy moving
- Two splitting speeds
- Brass guiding system
- High speed return
- Automatic log support arm
- Floor plate in full steel
- Female gear box pump (PTO model)



Ø 40 cm  
< 100 cm >



VELO9 M

Log splitter	VELO9 M	VELO9 T	VPF09	VES09
Tons (to)	9	9	9	9
Cutting length (cm)	108	108	108	108
Pump	double	single	single	double
Power supply	single-phased 230 V 2,2 kW	three-phase 400 V 4 kW	PTO tractor	Petrol Honda 5.5 HP
Speed 1 (cm/s)	6.6	7	8.1	6.3
Speed 2 (cm/s)	14.8	16.1	18.9	13.8
Return speed (cm/s)	11.2	11.9	13.5	11.2
Oil capacity (L)	13	13	13	13
Pump output (L/min)	18.6	16.5	14.7	19
Dimension (HxLxW cm)	250-182 *x80x80	250-182 *x80x80	250-182 *x80x80	250-182 *x80x80
Weight (kg)	225	225	220	230

Hydraulic and combines driving.  
CONTACT US

Cross splitter (Ref. FCX V9/HV/V55)

3-points tractor hitch for VEL/VPF/VPE09 (Ref. OPT00001)

400 V female plug (Ref. PRI F16)

Intermediate table for V09 with end sensor (Ref. TI V09)

PTO plug (Ref. PR000061)

\* Work - transport position

# Vertical splitter 12/16/20/25 Tons - V12/16/20/25 series

The options and accessories can be installed on the assembly line or afterwards.

See accessories page 24 & 25

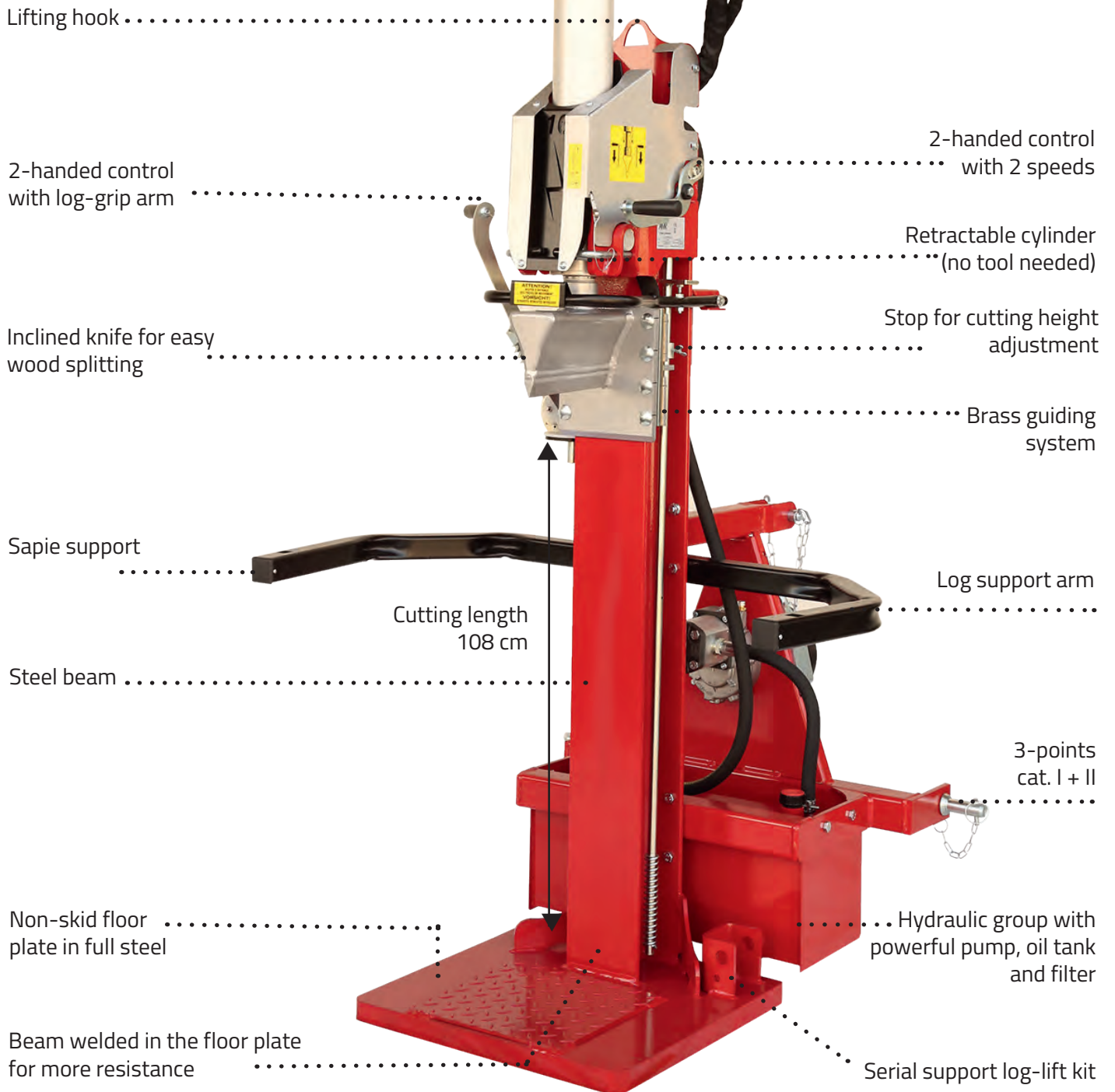



**Safety :**

The 2-handed control allows you to split logs safely. Your left hand is for holding the wood and your right hand activates the first then the second speed.

When you let go of both controls the cylinder will return automatically.



Ergonomic knife in wedge shape for splitting easily. Inclined returns to maintain the wood.

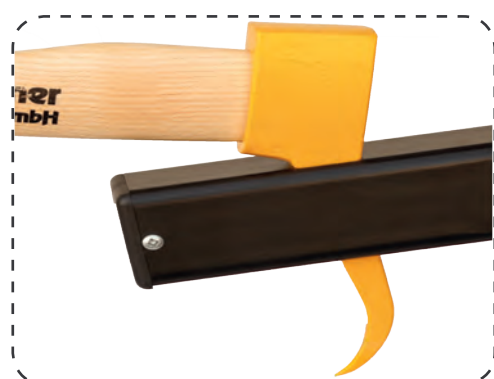

Sapie support for more comfort.

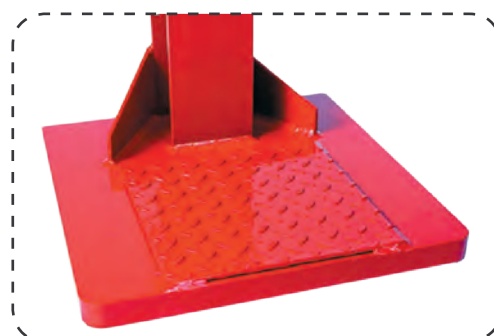
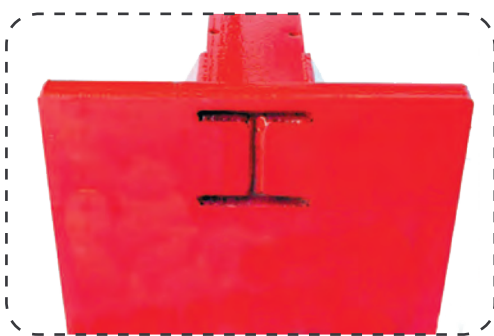

For robustness the steel beam is set into the floor plate and welded on both sides.

### ■ V12 series

The V12 series splitters are full of reliability and performance. They have double cylinder speed, automatic knife return, retractable cylinder, and they can have various accessories and options. Sapie support included.

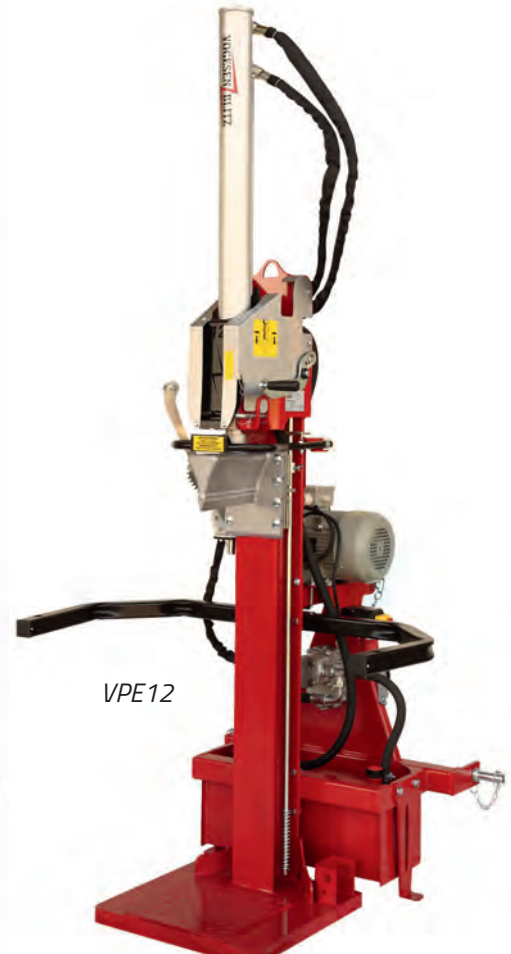

Log splitter	VEL12	VHY12	VPF12	VES12	VHE12	VPE12
Tons (to)	12	12	12	12	12	12
Cutting length (cm)	108	108	108	108	108	108
Pump	single	-	single	double	single	single/single
Power supply	three-phase 400 V 4 kW	hydraulic tractor	PTO tractor	petrol Honda 9 HP	hydraulic + Elec. 400 V	PTO tractor + Elec. 400 V
Speed 1 (cm/s)	7.7		11.4	14.1	*/7.7	11.4/7.7
Speed 2 (cm/s)	16.7	*	25.6	24.9	*/16.7	25.6/16.7
Return speed (cm/s)	12.5		18.9	22.3	*/12.5	18.9/12.5
Oil capacity (L)	28	*	28	28	28	28
Pump output (L/min)	21	*	37	37	*/21	37/21
Dimension (HxLxW cm)	250 (work position) / 190 (transport position) x 120 x 110 (68 on VHY12)					
Weight (kg)	360	275	320	345	360	370

\* Depending from tractor output

Supplement for 120 cm opening (cylinder 1 m)

Supplement for female pump on VPF12

See all options & accessories page 24 & 25

## Vertical splitter 16 Tons - V16 series

### ■ V16 series

The V16 series splitters are designed to be robust. They have double cylinder speed, automatic knife return, retractable cylinder, and they can have various accessories and options. Sapie support included.



Ø 80 cm  
< 100 cm >



Log splitter	VEL16	VHY16	VPF16	VES16	VHE16	VPE16
Tons (to)	16	16	16	16	16	16
Cutting length (cm)	108	108	108	108	108	108
Pumpe	double	-	single	double	double	single/double
Power supply	three-phase 400 V 4 kW	hydraulic tractor	PTO tractor	petrol Honda 9 HP	hydraulic + Elec. 400 V	PTO tractor + Elec. 400 V
Speed 1 (cm/s)	9.5		10.6	8.7	*/9.5	10.6/9.5
Speed2 (cm/s)	20.9	*	27.8	18.1	*/20.9	27.8/20.9
Return speed (cm/s)	14.2		16	11.3	*/14.2	16/14.2
Oil capacity (L)	28	*	28	28	28	28
Pump output (L/min)	42	*	54	37	*/42	54/42
Dimension (HxLxW cm)	250 (work position) / 190 (transport position) x 120 x 110 (68 on VHY16)					
Weight (kg)	390	310	360	370	395	410

\* Depending from tractor output

Supplement for 120 cm opening (cylinder 1 m)

Supplement for female pump on VPF16

See all options & accessories page 24 & 25

**Video on**  
[www.a-m-r.fr](http://www.a-m-r.fr)

### ■ V20 series

The V20 series splitters are designed to be robust, reliable and efficient. They have double cylinder speed, automatic knife return, retractable cylinder, and they can have various accessories and options. Sapie support included.



VPF20

	VEL20	VHY20	VPF20	VHE20	VPE20
Tons (to)	20	20	20	20	20
Cutting length (cm)	108	108	108	108	108
Pump	double	-	single	double	single/double
Power supply	three-phase 400 V 5,5 kW	hydraulic tractor	PTO tractor	hydraulic + Elec. 400 V	PTO tractor + Elec. 400 V
Speed 1 (cm/s)	7.9		10.8	*/7.9	10.8/7.9
Speed 2 (cm/s)	24.8	*	28	*/24.8	28/24.8
Return speed (cm/s)	15.4		16.4	*/15.4	16.4/15.4
Oil capacité (L)	40	*	40	40	40
Pump output (L/min)	52	*	60	*/52	60/52
Dimension (HxLxW cm)	264 (work position) / 190 (transport position) x 120 x 120				
Weight (kg)	500	425	475	450	510

\* Depending from tractor output

Supplement for 120 cm opening (cylinder 1 m)

See all options & accessories page 24 & 25

## Vertical splitter 25 Tons - V25 series

### ■ V25 series

The V25 series splitters are designed to be robust, reliable and efficient. They have double cylinder speed, automatic knife return, retractable cylinder, and they can have various accessories and options. Sapie support and cast iron pump included.



Ø 100 cm  
< 100 cm >

Video on  
[www.a-m-r.fr](http://www.a-m-r.fr)

VPF25



Log splitter	VEL25	VPF25	VPE25
Tons (to)	25	25	25
Cutting length (cm)	108	108	108
Pump	double	single	single/double
Power supply	three-phase 400 V 5.5 kW	PTO tractor	PTO tractor + Elec. 400 V
Speed 1 (cm/s)	8	10.1	10.1/8
Speed 2 (cm/s)	16.2	30.3	30.3/16,2
Return speed (cm/s)	11.7	14.9	14.9/11.7
Oil capacity (L)	62	62	62
Pump output (L/min)	52	70	70/52
Dimension (HxLxW cm)	264 (work position) / 190 (transport position) x 120 x 120		
Weight (kg)	545	530	580

\* Depending from tractor output

Supplement for 120 cm opening (cylinder 1 m)

See all options & accessories page 24 & 25

## COMPLETE YOUR LOG SPLITTER BY ADDING FUNCTIONS

## Accessories - V12/16/20/25 Series

The options and accessories can be installed on the assembly line or afterwards.

If you order a log winch kit, please give us the model, year and if your splitter has an hydraulic log lift.

If you order an oil cooler set, please tell us if you already have a log winch and/or a mechanical log lift.



Intermediate support for splitter and bundler



Mechanical log lift



Hydraulic log lift

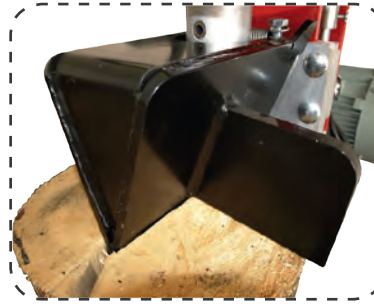

Cross splitter



Intermediate table



Sapie



Wheels and handling lever (3 wheels), 2 wheels for VHY models

Transformation kit VHY12 to VPF12*	Ref. TRA12 VHY-VPF
Transformation kit VHY16 to VPF16*	Ref. TRA16 VHY-VPF
Transformation kit VPF12 VPE12 SP*	Ref. TRA12 VPF-VPE SP
Transformation kit VPF16 to VPE16*	Ref. TRA16 VPF-VPE DP
Intermediate support for splitter and bundler (large-angle PTO shaft recommended) V12/13/16/17	Ref. SIFF
Cross splitter 12/16	Ref. FCX 12/16
Cross splitter 20/25	Ref. FCX 20/25
Split-wedge 12/16	Ref. ECL 12/16
Split-wedge 20/25	Ref. ECL 20/25
Intermediate table V12 / V16	Ref. TI 12 / TI 16
Intermediate table V20 / V25	Ref. TI 20 / TI 25
Mechanical log lift V12 / V16	Ref. LBM 12/16
Mechanical log lift V20 / V25	Ref. LBM 20/25
Hydraulic log lift V12 / V16	Ref. LBH 12/16
Hydraulic log-lift V20 / V25	Ref. LBH 20/25
Wheels and handling lever 12/13/16/17 (3 wheels) Cat.2	Ref. RTM VPF12/13/16/17
Wheels and handling lever 12/13/16/17 for hydraulic model (2 wheels) Cat.2	Ref. RTM VHY12/13/16/17
Oil cooler set 12/13/16/17 (for intensive use)	Ref. SET REF12/13/16/17
Oil cooler set 20/22/25/27 (for intensive use)	Ref. SET REF20/22/25/27
PTO shaft (type 3)	Ref. CAR01
Tachometer and hour meter VPF/VPE for PDF	Ref. CPT HOR 12/13/16/17/20/22/25/27
Sapie 380 mm / 800 mm	Ref. SAP 380 - Réf. SAP 800



## Log winch for splitters mechanical or radio controlled

COMPLETE YOUR LOG SPLITTER  
BY ADDING FUNCTIONS

Hydraulic log winch with radio control  
(need 12V) for vertical model,  
with hook.

Video on  
[www.a-m-r.fr](http://www.a-m-r.fr)

### ■ Log winch

The log winch can pull 600 kg logs on a 20 m distance. The hydraulic winch is available in radio (need 12 V) or mechanical control. Can be adapted on splitter V12 / 13 / 16 / 17 / 20 / 22 / 25 / 27 T and H28 T (for 28 T, needs 12 V and hydraulic from tractor).

- Traction power : 600 kg
- Cable average speed : 0,5 m/s
- Cable length : 20 m
- Ø cable : 6 mm
- Weight : 75 kg

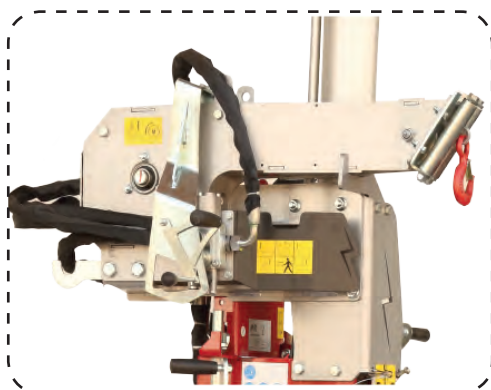

Hydraulic log winch with mechanical control  
for vertical model



Mechanical log winch V12/16	Ref. TTB 12/16 M2
Mechanical log winch V13/17	Ref. TTB 13/17 M2
Mechanical log winch V20/25	Ref. TTB 20/25 M2
Mechanical log winch V22/27	Ref. TTB 22/27 M2
Radio controlled log winch V12/16	Ref. TTB 12/16 R2
Radio controlled log winch V13/17	Ref. TTB 13/17 R2
Radio controlled log winch V20/25	Ref. TTB 20/25 R2
Radio controlled log winch V22/27	Ref. TTB 22/27 R2
Radio controlled log winch H28 for model on farm axle	Ref. TTB 28ESS R2
Radio controlled log winch H28	Ref. TTB 28 R2
Pliers for winch 70 cm 2000 kg	Ref. PINCE OUV 700
Pliers for winch 55 cm 1500 kg	Ref. PINCE OUV 550
Hook for winch	Ref. CRO FRAP

Log winches can be assembled  
on factory or afterwards with  
our kits.

Please tell us your splitter model,  
power supply, year, and if it has an  
hydraulic log-lift.

According to regulation, a winch can  
be used only when the splitter is  
linked to a tractor.

**PROFESSIONAL, HEAVY DUTY LOG SPLITTING!**

13 - 17 - 22 - 27 Tons

- >> More power
- >> More safety
- >> More comfort



*European safety  
standard  
EN 609-1*



Safety trophy  
Forexpo 2016



Innovation trophy  
Space 2016



GS safety certification  
(German security test)



Video on  
[www.a-m-r.fr](http://www.a-m-r.fr)

Cylinder stroke with 105 cm retractable without tools

New mechanism, smoother and stronger with a latching system (good for short logs)



Design thermoformed hood



Adjustable claw to hold all logs (from 8 cm)



Mechanical lift (really convenient)

Larger and sharper knife



Larger log support arm with adjustable claw for wood, and sapie support

Cutting length 115 cm

3-points cat. I + II



Non-skid plate in full steel with angled edges to facilitate timber handling

Cast iron pump, silent and robust. Bigger tank.

Massive beam

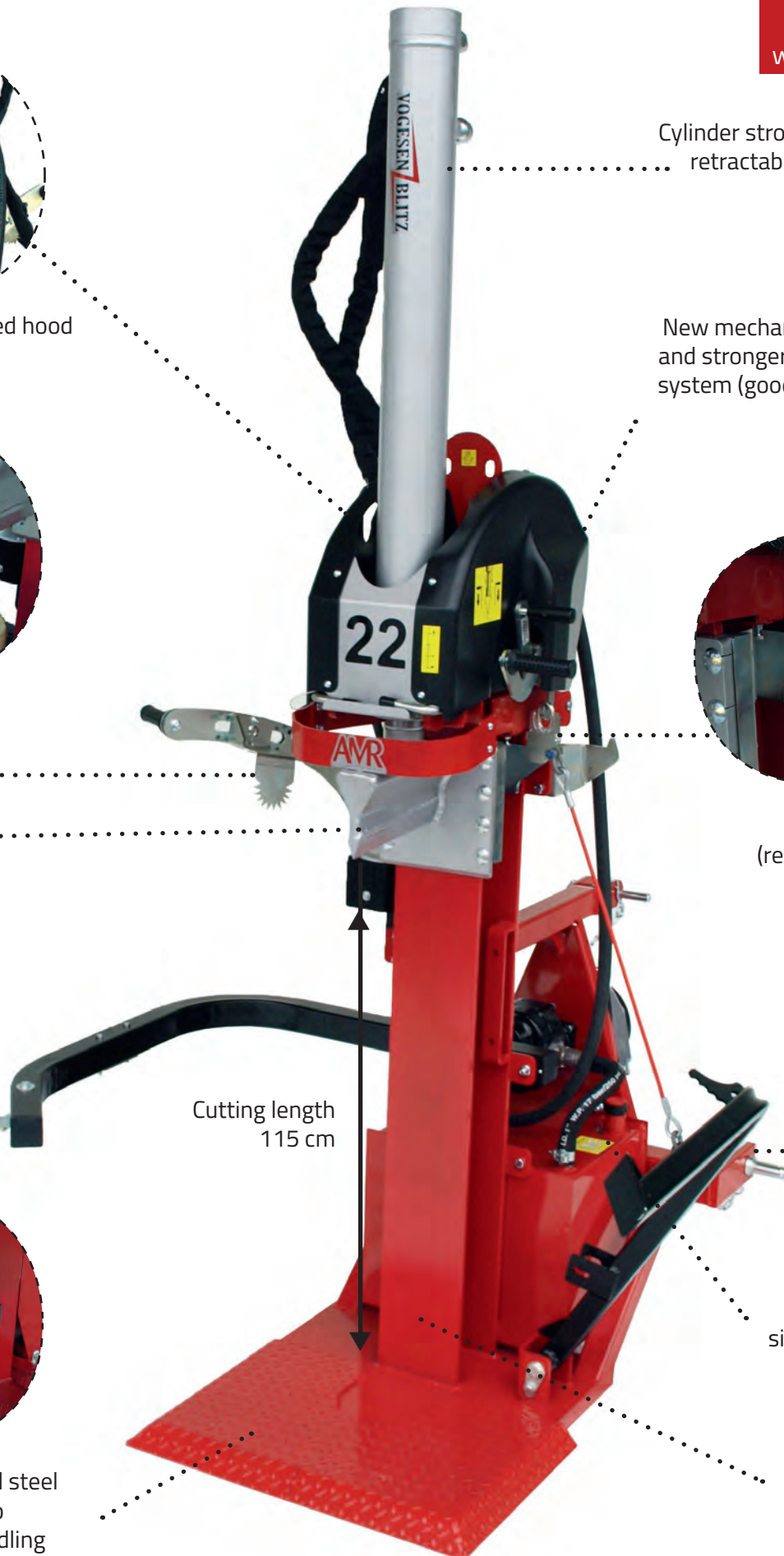

### ■ V13 series

This splitter has been improved in ergonomics, power and speeds, and is also conform to safety standard EN609-1.

- Maximal safety for work
- 2-handed control
- Mechanical log-lift
- 115 cm opening
- Retractable cylinder for storage
- 2 speeds
- Brass guiding system with grease point
- Non-skid plate in full steel with angled edges
- Aluminium pump



Ø 70 cm  
< 115 cm >



NEW

PATENTED

VPE13  
with hydraulic log-lift

Log splitter	VEL13	VHY13	VPF13	VHE13	VPE13
Tons (to)	13	13	13	13	13
Cutting length (cm)	115	115	115	115	115
Pump	single	-	single	single	single/single
Power supply	three-phase 400 V 6.6 kW	hydraulic tractor	PTO tractor	hydraulic + Elec. 400 V	PTO tractor + Elec. 400 V
Speed 1 (cm/s)	7.4		10.6	*/7.4	10.6/7.4
Speed 2 (cm/s)	20	*	26	*/20	26/20
Return speed (cm/s)	11.5		18	*/11.5	18/11.5
Oil capacity (L)	28	*	28	28	28
Pump output (L/min)	28	*	45	*/28	45/28
Dimension (HxLxW cm)	262 (work position) / 200 (transport position) x 135 x 120				
Weight (kg)	425	340	395	430	440

\* Depending from tractor output

See all options & accessories page 32 & 33

## Vertical splitter 17 Tons - V17 series

### ■ V17 series

This splitter has been improved in ergonomics, power and speeds, and is also conform to safety standard EN609-1.

- Maximal safety for work
- 2-handed control
- Mechanical log-lift
- 115 cm opening
- Retractable cylinder for storage
- 2 speeds
- Brass guiding system with grease point
- Non-skid plate in full steel with angled edges
- Cast iron pump (on PTO)



Ø 80 cm  
< 110 cm >



Video on  
[www.a-m-r.fr](http://www.a-m-r.fr)

VPF17

Log splitter	VEL17	VHY17	VPF17	VHE17	VPE17
Tons (to)	17	17	17	17	17
Cutting length (cm)	115	115	115	115	115
Pump	double	-	single	double	single/double
Power supply	three-phase 400 V 4,8 kW	hydraulic tractor	PTO tractor	hydraulic + Elec. 400 V	PTO tractor + Elec. 400 V
Speed 1 (cm/s)	9.5		11.8	*/9.5	11.8/9.5
Speed 2 (cm/s)	21	*	27.9	*/20.9	27.9/21
Return speed (cm/s)	14.2		17.6	*/14.2	17.6/14.2
Oil capacity (L)	28	*	28	28	28
Pump output (L/min)	43	*	57	*/43	57/43
Dimension (HxLxW cm)	262 (work position) / 200 (transport position) x 135 x 120				
Weight (kg)	445	360	420	450	465

\* Depending from tractor output

See all options & accessories page 32 & 33

### ■ V22 series

This splitter has been improved in ergonomics, power and speeds, and is also conform to safety standard EN609-1.

- Maximal safety for work
- 2-handed control
- Mechanical log-lift
- 115 cm opening
- Retractable cylinder for storage
- 2 speeds
- Brass guiding system with grease point
- Non-skid plate in full steel with angled edges
- Cast iron pump (on PTO)



Ø 100 cm  
< 110 cm >



VPF22

Log splitter	VEL22	VHY22	VPF22	VHE22	VPE22
Tons (to)	22	22	22	22	22
Cutting length (cm)	115	115	115	115	115
Pump	double	-	single	double	single/double
Power supply	three-phase 400 V 6.6 kW	hydraulic tractor	PTO tractor	hydraulic + Elec. 400 V	PTO tractor + Elec. 400 V
Speed 1 (cm/s)	8		11.4	* / 8	11.4 / 8
Speed 2 (cm/s)	24.8	*	23.3	* / 24.8	23.3 / 24.8
Return speed (cm/s)	15.4		17.1	* / 15.4	17.1 / 15.4
Oil capacity (L)	62	*	62	62	62
Pump output (L/min)	58	*	69	* / 58	69 / 58
Dimension (HxLxW cm)	264 (work position) / 202 (transport position) x 155 x 150				
Weight (kg)	560	490	545	565	615

\* Depending from tractor output

See all options & accessories page 32 & 33

## Vertical splitter 27 Tons - V27 series

### ■ V27 series

This splitter has been improved in ergonomics, power and speeds, and is also conform to safety standard EN609-1.

- Maximal safety for work
- 2-handed control
- Mechanical log-lift
- 115 cm opening
- Retractable cylinder for storage
- 2 speeds
- Brass guiding system with grease point
- Non-skid plate in full steel with angled edges
- Cast iron pump (on PTO)



∅ 100 cm  
< 110 cm >



VPF27

Log splitter	VEL27	VPF27	VPE27
Tons (to)	27	27	27
Cutting length (cm)	115	115	115
Pump	double	single	single/double
Power supply	three-phase 400 V 6.6 kW	PTO tractor	PTO tractor + Elec. 400 V
Speed 1 (cm/s)	8	10.3	10.3/8
Speed 2 (cm/s)	16.2	30.4	30.4/16.2
Return speed (cm/s)	11.7	15.3	15.3/11.7
Oil capacity (L)	70	70	70
Pump output (L/min)	58	81	81/58
Dimension (HxLxW cm)	264 (work position) / 202 (transport position) x 155 x 150		
Weight (kg)	615	600	670

See all options & accessories page 32 & 33

## COMPLETE YOUR LOG SPLITTER BY ADDING FUNCTIONS

## Accessories - V13/17/22/27 series



Mechanical log-lift  
included



Hydraulic log-lift  
(option)



Sapie  
length 380 or 800 mm



Wheels and handling lever (3 wheels)  
– 2 wheels for VHY 13/17



Tachometer and hour meter  
(for PTO)



Hook & pliers 55 or 70 cm

Options and accessoires for V13/17/22/27 series can be assembled in the factory or afterwards with our kits.

If you order a log winch kit, please give us the model, year and if your splitter has an Hydraulic log-lift.

If you order an oil cooler set, please tell us if you already have a log winch and/or a mechanical log- lift.

Transformation kit VHY13 to VPF13*	Ref. TRA13 VHY-VPF
Transformation kit VHY17 to VPF17*	Ref. TRA17 VHY-VPF
Transformation kit VPF22 to VPE22*	Ref. TRA22 VPF-VPE SP
Intermediate support for splitter and bundler V12/13/16/17	Ref. SIFF
Hydraulic log-lift V13 / V17	Ref. LBH 13/17
Hydraulic log-lift V22 / V27	Ref. LBH 22/27
Wheels and handling lever 12/13/16/17 (3 wheels) Cat.2	Ref. RTM VPF12/13/16/17
Wheels and handling lever 12/13/16/17 for VHY (2 wheels) Cat.2	Ref. RTM VHY12/13/16/17
Oil cooler set 12/13/16/17	Ref. SET REF12/13/16/17
Oil cooler set 20/22/25/27 (for intensive use recommended)	Ref. SET REF20/22/25/27
PTO shaft type 3	Ref. CAR01
Tachometer and hour meter for PTO	Ref. CPT HOR 12/13/16/17/20/22/25/27
Sapie 380 mm / 800 mm	Ref. SAP 380 - Réf. SAP 800



# COMPLETE YOUR LOG SPLITTER BY ADDING FUNCTIONS

Hydraulic log winch with  
mechanical control  
Logs until 600 kg  
*More information p.25*



Video on  
[www.a-m-r.fr](http://www.a-m-r.fr)

Hydraulic log winch with radio  
control. Logs until 600 kg  
*More informations  
p.25*



Mechanical log winch V13/17	Ref. TTB 13/17 M2
Mechanical log winch V22/27	Ref. TTB 22/27 M2
Radio controlled log winch V13/17	Ref. TTB 13/17 R2
Radio controlled log winch V22/27	Ref. TTB 22/27 R2
Pliers for log winch 2 T opening 70 cm	Ref. PINCE OUV 700
Pliers for log winch 1.5 T opening 55 cm	Ref. PINCE OUV 550
Hook for log winch	Ref. CRO FRAP

16 Tons splitter on road homologated chassis - VMR



Video on  
[www.a-m-r.fr](http://www.a-m-r.fr)



## Road homologated splitter 12/16 Tons - VMR series

### VMR series

VMR splitters are vertical on homologated chassis. They combine effectiveness and robustness, for great mobility and autonomy.

- Comfort : hydraulic tilting splitter in working position
- Handle and claw holding arm
- Security : 2-handed control
- Two speeds
- Automatic cylinder lift
- Brass guiding system
- Non-skid floor plate in full steel
- Road homologation according to directive 2007/46 / EC
- Electric start on diesel engine
- Sapie support



12 To  $\varnothing$  70 cm  
< 100 cm >



16 To  $\varnothing$  80 cm  
< 100 cm >

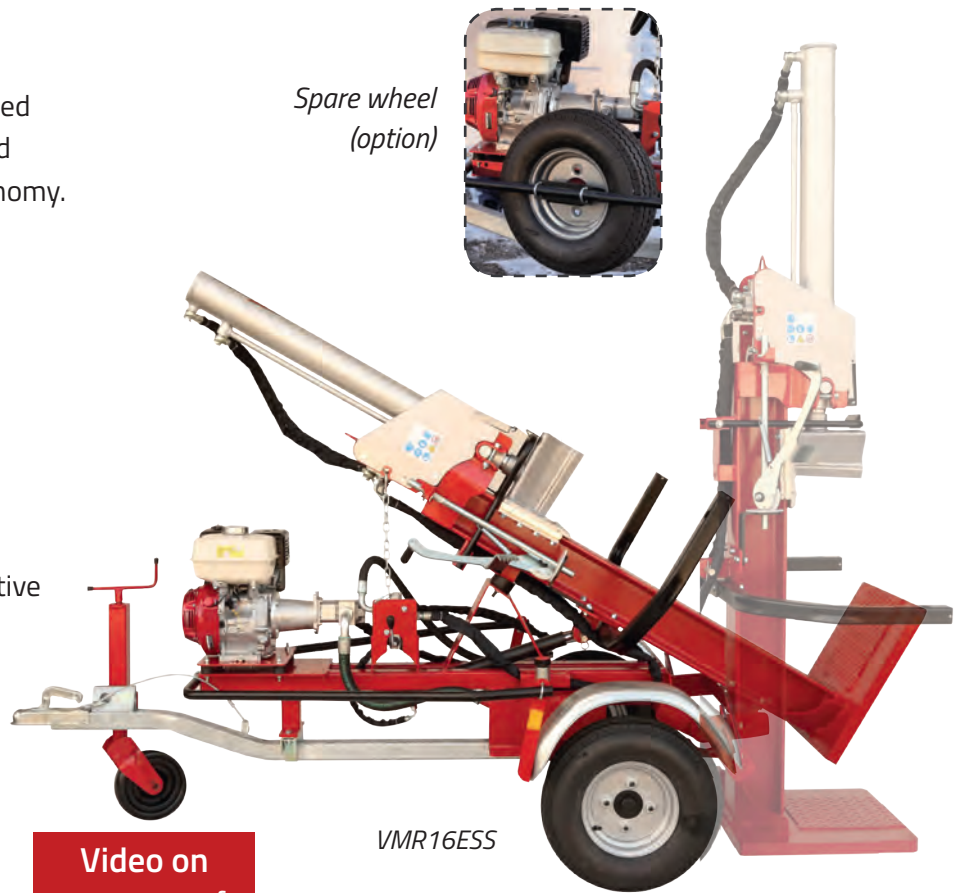

Spare wheel  
(option)

VMR16ESS

Video on  
[www.a-m-r.fr](http://www.a-m-r.fr)

Log splitter	VMR12ESS SP	VMR12ESS DP	VMR12DIE SP	VMR12DIE DP	VMR16ESS-9 DP	VMR16ESS-13DP	VMR16DIE DP
Road homologation according to directive 2007/46 / EC (additional fee)							
Tons (to)	12	12	12	12	16	16	16
Cutting length (cm)	108	108	108	108	108	108	108
Pump	single	double	single	double	double	double	double
Power supply	Honda 9 HP	Honda 9 HP	Diesel 9 HP	Diesel 9 HP	Honda 9 HP	Honda 13 HP	Diesel 9 HP
Fuel capacity	5.3 L	5.3 L	5.5 L	5.5 L	5.3 L	6.1 L	5.5 L
Speed 1 (cm/s)	8	14	8	14	9	9	9
Speed 2 (cm/s)	20	25	20	25	19.7	19.7	19.7
Return speed (cm/s)	12	22	12	22	13.3	13.3	13.3
Oil capacity (L)	24	24	24	24	24	24	24
Pump output (L/min)	14	36.2	14	36.2	36.2	36.2	36.2
Dimension (HxLxW cm)	transport : 186 x 126 x 295 / work : 250 x 126 x 287						
Weight (kg)	520	520	530	530	560	570	570
Electrical, PTO or combined driving. CONTACT US	Supplement for chassis with brake for parking (Ref. FREIN VMR)						
	Cross splitter 12/16 (Ref. FCX 12/16)						
	Intermediate table 12 t / 16 t (Ref. TI 12 / Réf. TI 16)						
	Hydraulic log-lift V12/16 for VMR (Ref. LBH 12/16 VMR)						
	Mechanical log-lift V12/16 (Ref. LBM 12/16)						
According to the regulation, it's not possible to use a winch of a splitter on chassis.	Spare wheel with support (Ref. ROUE SEC VMR)						

## Road homologated splitter 17 Tons - VMR17 series

### ■ VMR17 series

VMR17 splitters are vertical and on a road-homologated chassis. They combine effectiveness and robustness and stand for great mobility and autonomy. Conform to the new safety standard EN609-1.

- Comfort : hydraulic tilting splitter in working position
- Safety : 2-handed control
- 2 splitting speeds
- Road homologation according to directive 2007/46 / EC
- Electric start on diesel engine
- 115 cm opening
- Adjustable claw to hold all logs (from 8cm)
- Log support arm with adjustable claw for wood and sapie support
- Mechanical log-lift included (really convenient)
- Non-skid plate in full steel with angled edges to facilitate timber handling
- Cylinder stroke retractable without tools



Ø 80 cm  
< 110 cm >



Log splitter	VMR17ESS-9DP	VMR17ESS-13DP	VMR17DIE DP
Road homologation according to directive 2007/46 / EC (additional fee)			
Tons (to)	17	17	17
Cutting length (cm)	115	115	115
Pump	double	double	double
Power supply	petrol Honda 9 HP	petrol Honda 13 HP	Diesel 9 HP
Fuel capacity	5.3 L	6.1 L	5.5 L
Speed 1 (cm/s)	9.1	9.1	9.1
Speed 2 (cm/s)	20.3	20.3	20.3
Return speed (cm/s)	12.8	12.8	12.8
Oil capacity (L)	24	24	24
Pimp output (L/min)	36.2	36.2	36.2
Dimension (HxLxW cm)	transport : 195 x 126 x 303 / work : 260 x 126 x 318		
Weight (kg)	550	550	550
According to the regulation, it's not allowed to use a winch of a splitter on chassis	Supplement for chassis with brake for parking (Ref. FREIN VMR)		
	Hydraulic log-lift for VMR17 (Ref. LBH 17 VMR)		
	Spare wheel with support (Ref. ROUE SEC VMR)		

### ■ VMR-S series

Ensure freedom with this road non-homologated splitter !  
A robust chassis and wheels expected for offroad. You are now ready to split offroad, with a quad for example.

- Mechanical tilting with winch included
- Petrol engine Vanguard 10 HP with double pump
- Cylinder stroke retractable without tools
- For robustness the steel beam is set into the floor plate and welded on both sides
- Safety : 2-handed control
- 2 splitting speeds
- Brass guiding system
- Road non-homologated



like road homologated models



VMR-S16



VMR-S17

VMR-S17 fits to the safety standard EN609-1

- Opening : 115 cm
- Adjustable claw to hold all logs (from 8 cm)
- Log support arm with adjustable claw for wood and sapie support
- Mechanical log-lift included (really convenient)
- Non-skid plate in full steel with angled edges to facilitate timber handling

Log splitter	VMR-S12 ESS DP	VMR-S16 ESS DP	VMR-S17 ESS DP
Tons (to)	12	16	17
Cutting length (cm)	108	108	115
Pump	Double	Double	Double
Power supply	petrol Vanguard 10 HP	petrol Vanguard 10 HP	petrol Vanguard 10 HP
Fuel capacity	5.5 L	5.5 L	5.5 L
Speed1 / 2 / return (cm/s)	14.1 / 24.9 / 22.3	9.8 / 20.7 / 14.1	9.8 / 20.7 / 14.1
Oil capacity (L)	28	28	28
Pumpe output (L/min)	36.2	36.2	36.2
Dimension (HxLxW cm)	transport : 190 x 120 x 214 / work : 250 (260 en 17To) x 120 x 218		
Weight (kg)	395	430	470

According to the regulation, it's not allowed to use a winch of a splitter on chassis

Hydraulic log-lift V12/16 VMR (Ref. LBH 12/16 VMR)

Hydraulic log-lift V17 VMR (Ref. LBH 17 VMR)

Mechanical log-lift (only on 12/16 t / already included on 17 t) (Ref. LBM 12/16)

Intermediate table (only on 12/16 t) (Ref. TI 12/TI 16)

Cross splitter (only on 12/16 t) (Ref. FCX 12/16)

# Crane splitter 25 Tons - HHY25 GRUE Model

## ■ HHY25 model

Crane splitter with a 25 Tons power and 110 cm opening. This convenient splitter can be installed on front loader or forest crane.

- Retractable cylinder without tools
- Brass guiding system
- Robust and durable
- Recommended flow : 60 L/min



Ø 100 cm  
< 100 cm >



Log splitter	HHY25 GRUE
Tons (to)	25
Cutting / cylinder length (cm)	110 / 100
Power supply	hydraulic tractor
Speeds	depending from tractor output
Dimension (HxPxW cm)	60 x 65 x 198 (transport) / 258 (work)
Weight (kg)	400
Linkage for EURO front loader (Ref. ATT HH EURO)	
Linkage for rotator 30 (Ref. ATT HH 30)	
Linkage for rotator 46 (Ref. ATT HH 46)	
Linkage for rotator 46/48 (Ref. ATT HH 46/48)	

Linkage for rotator :

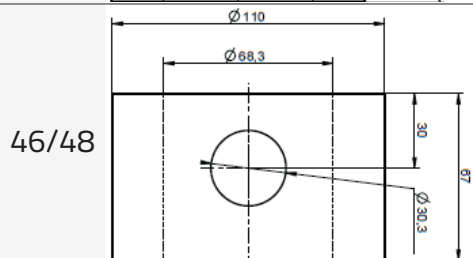
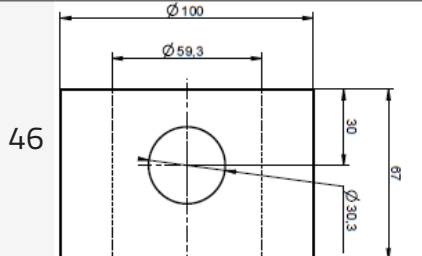
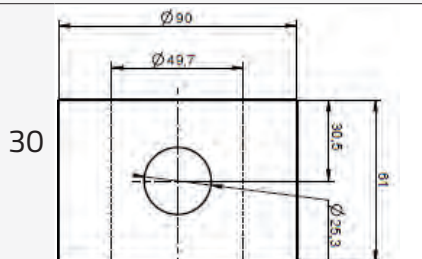

Video on  
[www.a-m-r.fr](http://www.a-m-r.fr)

# Horizontal Log splitter 17 Tons - H17 series

## ■ H17 series

Horizontal log splitter 17 tons with hydraulical adjustable knife.

- Foldable evacuation table for transport
- Two splitting-speeds
- Safety grid / Activator stops the pusher automatically
- 2/4 splinter knife, hydraulically adjustable
- 3-points hitch on tractor
- Cutting length 110 cm / cylinder length 105 cm

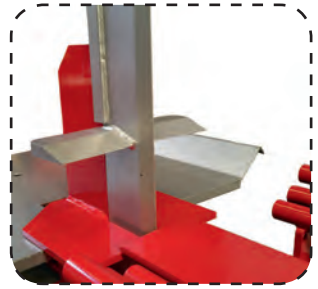

2/4 splinter knife, hydraulically adjustable



3-points hitch on tractor cat. I et II

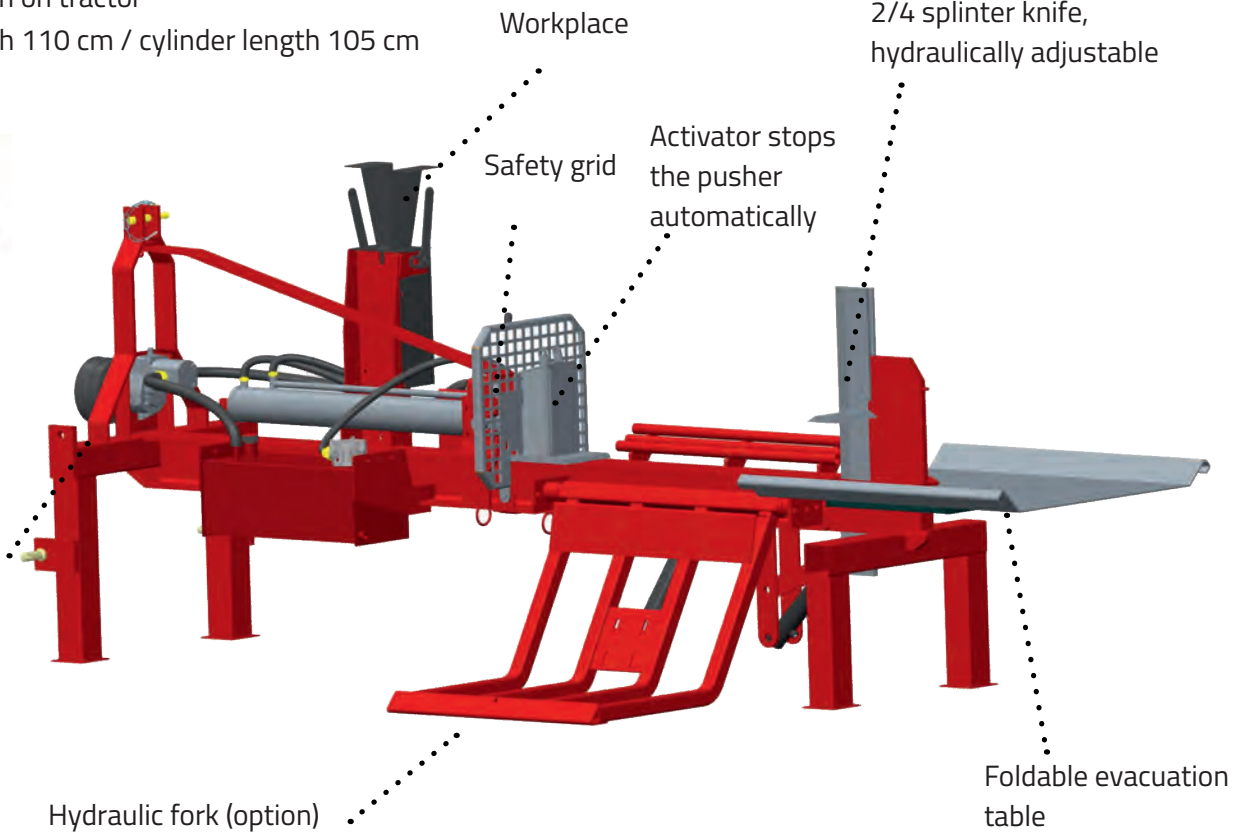

Log splitter	HEL17/1100 CR	HPF17/1100 CR
Tons (to)	17	17
Cutting length (cm)	110	110
Pump	double	single
Power supply	three-phase 400 V 4 kW	PTO tractor
Speeds 1 / 2 / return (cm/s)	9.5 / 20.9 / 14.2	11.8 / 27.9 / 17.6
Oil capacity (L)	28	28
Pump output (L/min)	42	57
Dimension (HxLxW cm)	155 x 100 x 330	155 x 100 x 330
Weight (kg)	590	575
Supplement for hydraulic fork		

**PTO + Electric combined  
CONTACT US**



# Horizontal splitter 16/25 Tons - H1100 Series

**CUSTOM-MADE POSSIBLE**

1

## ■ H1100 series

Ideal for post splitting, this horizontal splitter is available in 16 or 25 tons version, with a 110 cm opening.

- Safety : 2-handed control
- Cylinder stroke : 100 cm
- 2 splitting speeds
- Brass guiding system
- 3-points hitch cat. I and II (PTO)



HES16-1100  
Autonomous model on axle with fork (option) and hitch. Road not homologated.

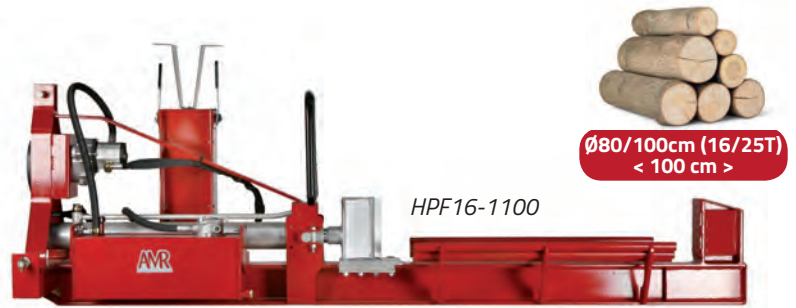

HPF16-1100  
with feet option, lifting fork and reversible split system

- Reversible split system for splitters 25 tons not available
- Cross splitter on 25 tons not recommended

Log splitter	HHY16-1100	HPF16-1100	HEL16-1100	HES16-1100	HPF25-1100	HEL25-1100
Optional : fork and feet						
Tons (to)	16	16	16	16	25	25
Cutting length (cm)	110	110	110	110	110	110
Pump	-	single	double	double	single	double
Power supply	hydraulic tractor	PTO tractor	three-phase 400 V	petrol Honda 9 HP	PTO tractor	three-phase 400 V
Speed 1 (cm/s)		10.6	9.5	8.7	10.1	8.2
Speed 2 (cm/s)	*	27.8	20.9	18.1	30.3	16.2
Return speed (cm/s)		16	14.2	11.3	14.9	11.7
Oil capacity (L)	*	28	28	28	50	50
Pump output (L/min)	*	54	42	42	70	52
Weight (kg)	250	310	310	470	450	530

**CUSTOM-MADE POSSIBLE**

Cylinder length and specific opening on demand (according to regulation and possibility). For example : 160 or 210 cm opening. Combined drive on demand.

**CONTACT US**

Supplement for hydraulic fork with speed regulation and feet

Supplement for feet without fork

PTO shaft type 3 (Ref. CAR01)

Cross splitter for 16 t (Ref. FCX HOR.16)

Supplement for reversible split system (only on 16 t)

\* Depending from tractor output



## Horizontal splitter 28 Tons H28 Series

This machine has been designed for professionals to create an efficient workplace

- Safety : 2-handed control
- Work comfort : lifting fork and large evacuation table
- 2/4 splinter knife, hydraulically adjustable
- Optimized efficiency with flow regulator, adapting splitting speed to needed power
- Easy to move : foldable table and cylinder, also available on transport axle
- Optional radio controlled log winch



Video on  
[www.a-m-r.fr](http://www.a-m-r.fr)



# Horizontal splitter 28 Tons on 3-point - H28 Series



Hydraulic log winch with radio control for H28. This option can be assembled in the factory or afterwards with our kits.

- Traction power : 600 kg
- Cable : 20 M length Ø 6 mm
- Cable average speed : 0.5 m / s
- 12 V and hydraulic from tractor required



Ø 110 cm  
< 120 cm >

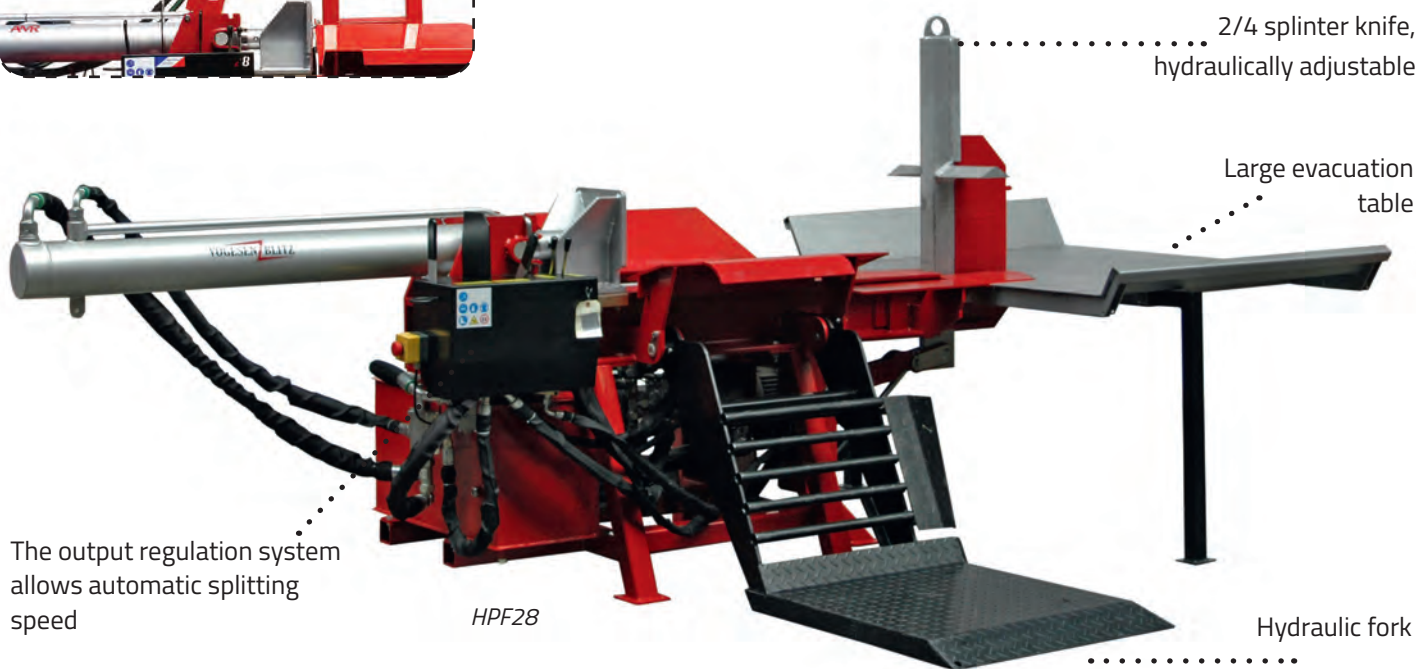

Log splitter	HPF28	HEL28	HPE28
Tons (to)	28	28	28
Cutting length (cm)	120	120	120
Pump	double	triple	double/triple
Power supply	PTO tractor	three-phase 400 V 9,2 kW	PTO tractor + Elec. 400 V
Automatic speed (cm/s)	24	22.7	24 / 22.7
Retun speed (cm/s)	21.8	16.2	21.8 / 16.2
Oil capacity (L)	85	85	85
Pump output (L/min)	89	87.8	89 / 87.8
Dimension (HxLxW cm)	transport : 194 x 178 x 325 / work : 133 x 226 x 405		
Weight(kg)	1005	1069	1075

**Log winch can be assembled in the factory or afterwards with our kits.**  
Tractor with double effect valve required

6 - way splitting knife (Ref. FCX-6/28T)

Log winch with radio control for 28 T (Ref. TTB 28 R2)

PTO shaft type 3 (Ref. CAR01)

# Horizontal splitter 28 Tons on axle - H28 ESS series



Ø 110 cm  
< 120 cm >



Hydraulic log winch with radio control for H28. This option can be assembled in the factory or afterwards with our kits.

- Traction power : 600 kg
- Cable : 20 M length Ø 6 mm
- Cable average speed : 0.5 m / s
- 12 V and hydraulic from tractor required

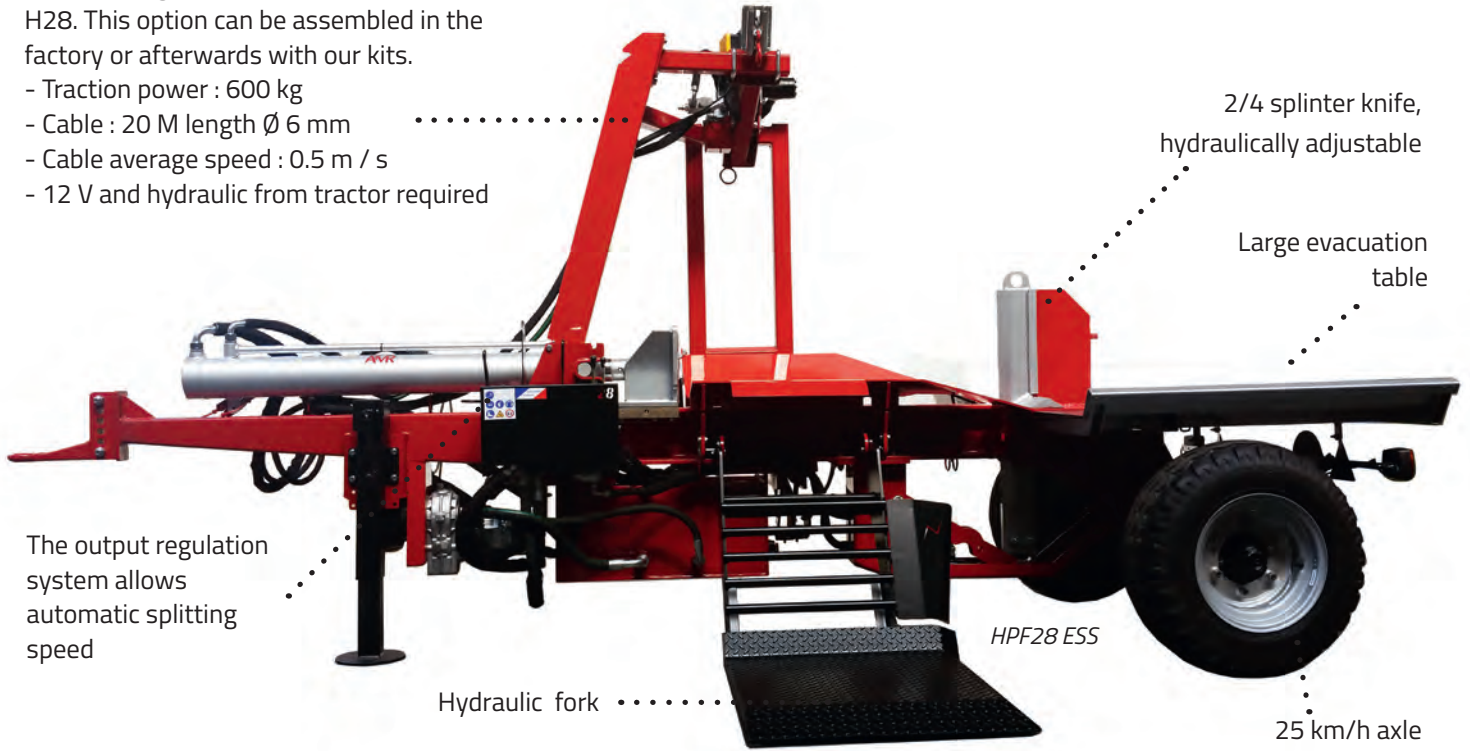

Log splitter	HPF28 ESS	HPE28 ESS
Tons (to)	28	28
Cutting length (cm)	120	120
Pump	double	double/triple
Power supply	PTO tractor	PTO tractor + Elec. 400 V
Automatic speed (cm/s)	24	24 / 22.7
Return speed (cm/s)	21.8	21.8 / 16.2
Oil capacity (L)	85	85
Pump output (L/min)	89	89 / 87.8
Dimension (HxLxW cm)	194 x 190 x 473	194 x 190 x 473
Weight (kg)	1150	1330

Log winch can be assembled in the factory or afterwards with our kits. Tractor with double effect valve required	6 - way splitting knife (Ref. FCX-6/28T)
	Log winch with radio control for 28 T on axle (Ref. TTB 28ESS R2)
	PTO shaft, specific for 28 T on axle (Ref. CAR15)

## Kindlet, kindling machine

Performance, quality and time saving provided with Kindlet 200 and Kindlet Pro kindling machines. Machines for sticks production for firewood. Every 1.2 seconds (Pro model) the 5t powered splitting blade cuts kindling wood ready for use.

### **Fastest cycle time on the market !**

- Power : 4 and 5 tons
- Yield : 80 to 150 bags / hour
- Oil cooler included (PRO model)

## Wood to use

	Kindlet PRO	Kindlet 200
Ø max. of wood (cm)	25	20
Length as standard (cm)	15 / 20	15
Length kit in option (cm)	25 or 29	-
Type of wood <b>recommended</b> :	Resinous (pine) - birch - not stringy wood	
Type of wood <b>not recommended</b> :	knotty wood / wood pallet / timber drop	



Video on [www.a-m-r.fr](http://www.a-m-r.fr)

Kindling machine	KINDLET 200 M	KINDLET 200 T	KINDLET 200 PDF	KINDLET PRO T	KINDLET PRO PDF
Length kit as standard (cm)	15	15	15	standard : 20 option : 15/25/29	standard : 20 option : 15/25/29
Tons (to)	4	4	4	5	5
Cycle time (s)	2	2	2	1.2 (length 15 cm)	1.2 (length 15 cm)
Output max. (sack 24 L / hour)	80	80	80	150	150
Power supply	single-phased 230 V 2.2 kW	three-phase 400 V 3 kW	PTO tractor	three-phase 400 V 7.5 kW	PTO tractor
Supply conveyor (cm)	130	130	130	230	230
Evacuation conveyor (cm)	120	120	120	220	220
Dimension (HxLxW cm)	Kindlet 200 : 128 x 110 x 240 / Kindlet Pro : 140 x 140 x 280				
Weight (kg)	400	400	400	700	700

### TRANSFORMATION KIT

- > Kindlet 200 available only with 15 cm kit.
- > Kindlet PRO with 20 cm kit as standard. Optional kits available : 15, 25 and 29 cm.

Rotabagga (for 3 sacks 40 L) (Ref. ROT200 / ROTPRO)

3 kits for Kindlet Pro in option : 15, 25 and 29 cm (Ref. KIT)  
(kit contains : 15/25 cm = band + stop / 29 cm = band)

Sack 24 L - 500, 1000 or 2000 pieces (Ref. FILET 24)  
with zipper

Sack 40 L - 500, 1000 or 2000 pieces (Ref. FILET 40)  
with zipper

# SAWING RANGE

QUATR  MAT



„ More than 1500 Quatromat,  
drum saws sold !  
This figure speaks for itself!  
Our experience makes the difference.“

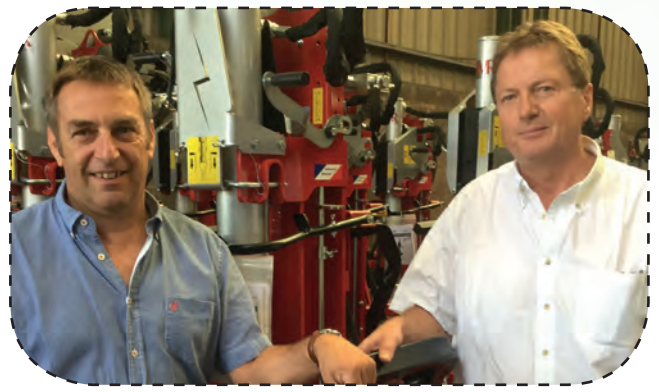

Gert Unterreiner & Michel Bechtel  
CEO AMR



Video on  
[www.a-m-r.fr](http://www.a-m-r.fr)



# AUTOMATIC SAWING *HIGH OUTPUT!*

Standard EN 1870-6

Video on  
[www.a-m-r.fr](http://www.a-m-r.fr)

- » Yield : 60 cutting/min
- » Comfort : cut length adjustable, from 25 to 50 cm or 20 to 40 cm without tools or dismantling
- » Safety : no direct access to blade

5m conveyor with individual sections. Tension setting and hydraulic unfolding

Safety grid

Drum with 4 chambers  
Protection from projection

Drum safety bar

Cut length adjustable from 25 to 50 cm or 20 to 40 cm no tools, no dismantling

Hydraulic independent system

Loading assistance with fork lift pockets







The blade is fully protected for safety but easily accessible for change



Log grip system locks the wood while sawing.



Cut length adjustable from 25 to 50 cm or 20 to 40 cm, without tools and dismantling.



European patent  
n° EP2705937



GS safety certification  
(German security test)

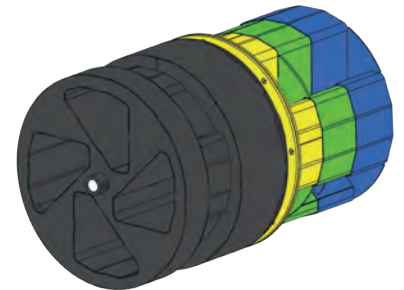

A drum in 3 parts  
The internal part is made up of 3 telescopic parts in order to guide the wood along the drum.



Wood disposal support

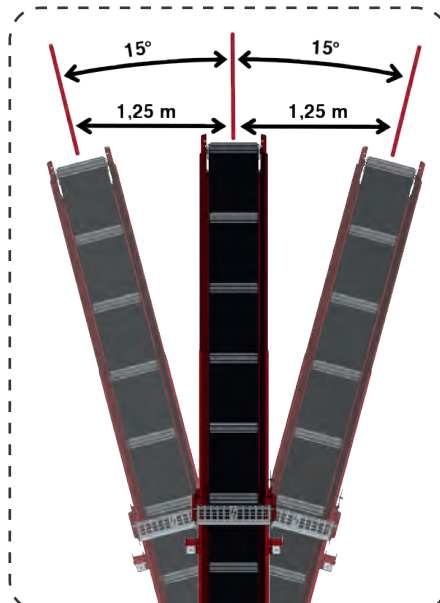

**European safety standard  
EN 1870-6**

The conveyor orientation setting makes easy loading wood in a trailer. Easy setting with central lever, that can be driven directly from operating place.



### ■ Automatic saw Quatromat - SAT4-700

The Quatromat circular saw allows the easy and quick sawing of round or split wood.

- Yield : until 12 steres/hr
- Cut length adjustable from 25 to 50 cm or 20 to 40 cm, no tools, no dismantling.
- 5 m x 35 cm belt with hydraulic roll
- Safety grid
- Drum rotational speed and conveyor speed adjustable
- Specific TCT blade, 700 mm x 6 mm thick
- Safety : no direct access to blade
- Wood disposal support included
- Torque limiter included
- Belt driven

### Operating mode

Load the splitted or round wood into the rotating chambers to be sawn to the required length. Cut logs exit onto the telescopic conveyor.

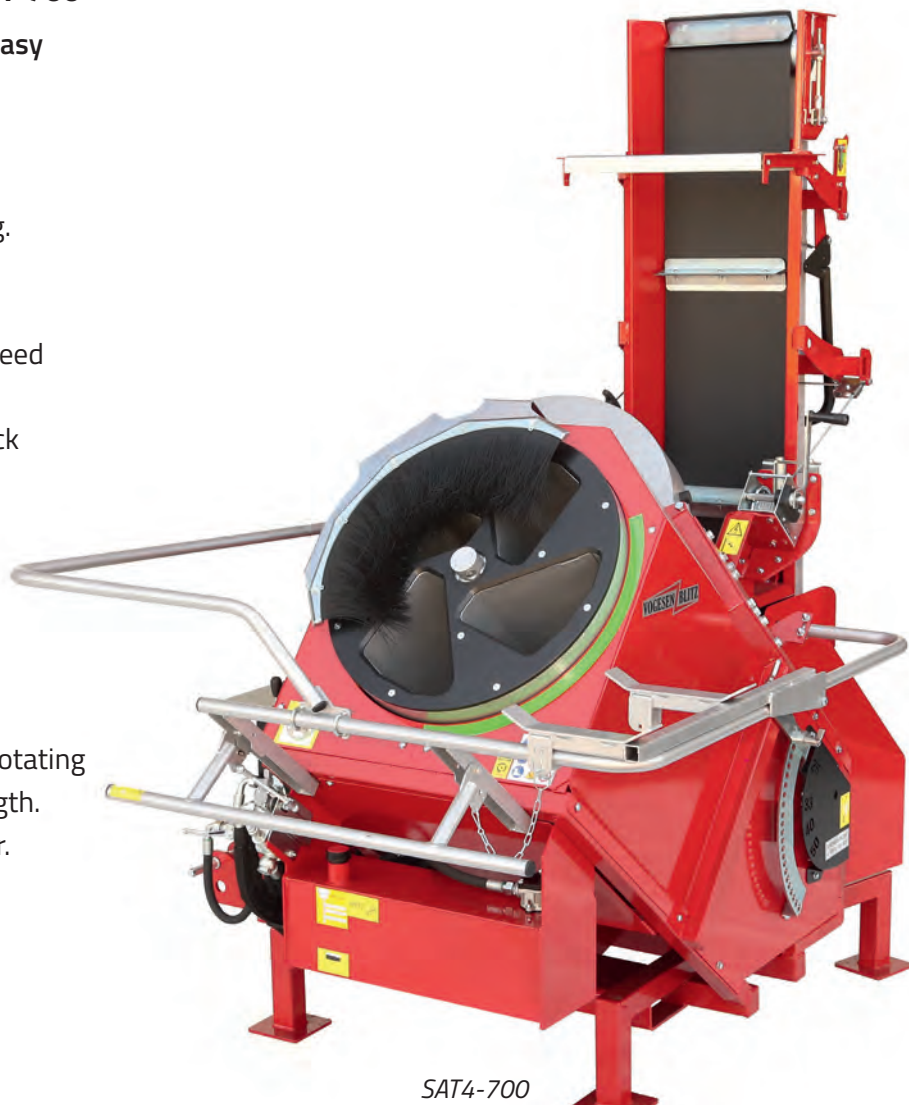

*SAT4-700  
in transport position*



*SAT 4-700  
with lighting  
ramp*



*SAT 4-700 with transport axle  
The option couples like a trailer and  
allows the saw to be transported, even  
from a 30/35 HP tractor.*

**Video on**  
[www.a-m-r.fr](http://www.a-m-r.fr)



## Automatic saw Quatromat

SAT4-700P-TH	PTO - 790 kg
SAT4-700PETH	PTO + Elec. 400 V 9.2 kW combined - 840 kg
SAT4-700P-THO	PTO, orientable conveyor - 890 kg
SAT4-700PE-THO	PTO + Elec. combined, orientable conveyor - 940 kg
SAT4-700P-ST	PTO, without conveyor
SAT4-700PE-ST	PTO + Elec. 400 V 9.2 kW combined, without conveyor
<b>Transformation set for fixed to orientable conveyor (from serial number 1021)</b>	
Number of chambers	4
Length of wood (m)	until 1
Max. Ø round log / split log (cm)	16 / 24
Max. cut / min	60
Cutting length (cm)	25, 33, 50 + middle or 20 to 40 + middle (on demand)
Pump	14 L with 540 t/min
TCT blade Ø 700 mm	6.0/4.5 Ø30 mm
Conveyor length (m) / Max high of evacuation (m)	5 / 3
3-point tractor	Cat. I et II
Dimension of transport (HxLxW cm)	245 x 210 x 160
Transport axle with lighting ramp (280 kg)	
TCT blade Ø700 mm x 6.0/4.5 Ø30 mm z=42	
Lighting ramp (Ref. RAM00100)	
Tachometer and hour meter (Ref. CPT HOR SAT)	
PTO shaft type 3 (Ref. CAR01)	
230 V plug for sawdust hoover (Ref. PROL SAT)	
Transformation kit PTO to PTO + Elec. (Ref. TRA SAT P-PE)	

If you order a transport axle afterwards, please tell us the serial number of the saw.

PATENTED

SOL  MAT





Video on  
[www.a-m-r.fr](http://www.a-m-r.fr)



# SEMI-AUTOMATIC SAWING *HOW DID WE DO IT BEFORE ?*

Standard EN 1870-6

- » Yield : until 7 steres/hr
- » Comfort : cut length adjustable from 20 to 52 cm without tools or dismantling
- » Safety : no direct access to blade

Video on  
[www.a-m-r.fr](http://www.a-m-r.fr)

Conveyor available in 2 or 5 M  
with individual sections

Serial wood disposal support

The tilting system  
is activated  
by a lever  
(option)

Safety grid

**NEW**

**Hydraulic tilting  
system (option)**

- ++ Working ergonomics
- ++ Longer durability  
of the blade
- ++ Adjustment of the  
tilting system is possible  
(10-35 cuts/min)

Loading assistance with  
fork lift pockets

Cutting length adjustable  
from 20 to 52 cm without  
tools or dismantling

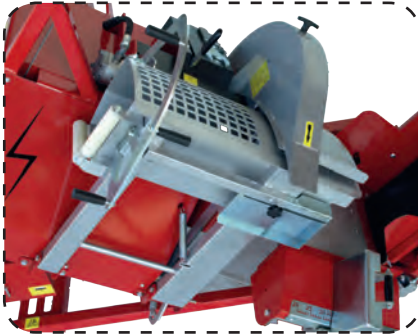

The blade is fully protected for safety but easily accessible for change

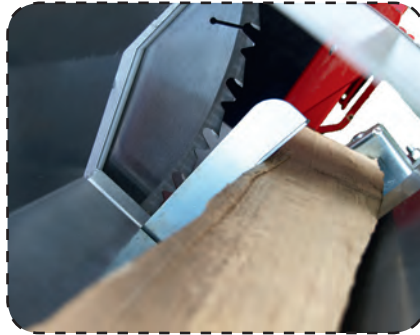

Log grip system locks the wood while sawing

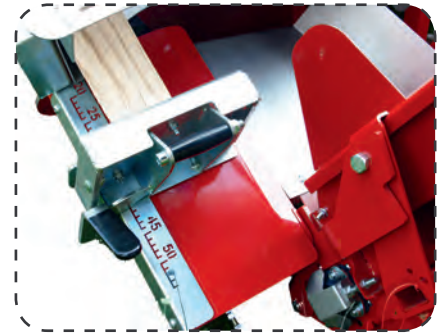

Setting the cutting length of 20-52 cm with a notch lever



European patent  
n° EP2939805

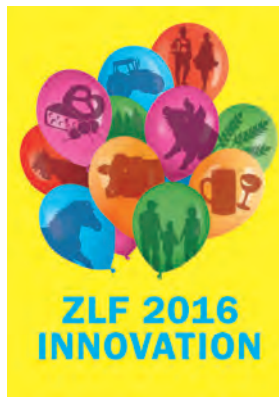

< Innovation trophy  
ZLF 2016



*European  
safety standard  
EN 1870-6*



..... **Hydraulic tilting system option\***

Ergonomics, this function prevents the operator from repetitive movement to push the tilting system for every cut. Maximal safety assured : no direct access to blade, no risk of projection. Regular cutting speeds preserves the blade.

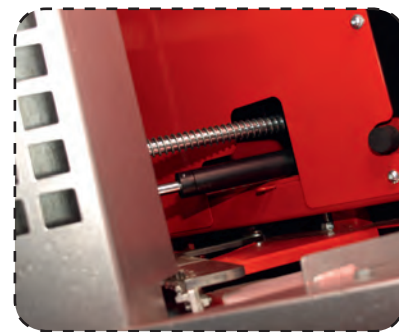

Sawdust evacuation



Wood disposal support as standard

**\*This option can be installed as a kit on all Solomat also in service.**



### ■ Circular tilting saw - Solomat

Sawing quickly and safely come directly with Solomat. This patented innovation was designed to be an effective tool with maximal safety and high efficiency. European standard EN 1870-6.

- High output thanks to the semi-automatic sawing.
- Safety : no direct access to blade
- Comfort : wood disposal support included, cut length adjustable from 20 to 52 cm + middle without tools and dismantling
- Option hydraulic tilting system. Ergonomics allows high work comfort.
- New serial TCT blade : Ø 700 mm – width 5mm
- Power supply : electric engine 400 V 7,5 kW, PTO or combined
- Option : 2 or 5 meters conveyor (width 35 cm). Hydraulic unfolding on 5 meters conveyor. Adjustable speed of the conveyor. Individual sections and safety grid
- Belt driven

### Operating mode

The specific tilting inclination allows the sawn log to fall onto the outfeed conveyor, and also the new log to reach the stop before being sawn. This creates a cut and evacuation automation for improved yield. The operator's role is only loading wood and using the tilting bed (mechanical or hydraulically). A log grip system holds wood during the sawing process.

With Solomat, the operator has no access to blade during sawing



*SIT-700P  
with 5 m conveyor*



*SIT-700P  
in transport position*

Video on  
[www.a-m-r.fr](http://www.a-m-r.fr)





Solomat	SIT-700E	SIT-700P	SIT-700PE
Without conveyor	SIT-700EST	SIT-700PST	SIT-700PEST
2 M conveyor	SIT-700E2	SIT-700P2	SIT-700PE2
2 M conveyor	SIT-700E5	SIT-700P5	SIT-700PE5

**NEW**

**Hydraulic tilting system**  
(Can be ordered ready-installed or as a kit)

Power supply	three-phase 7.5 kW 400 V	PTO tractor	PTO + Elec. 400 V
TCT blade Ø and width (mm)	700 - 5.0/4.0	700 - 5.0/4.0	700 - 5.0/4.0
Length / Ø wood max. (cm)	120 / 22	120 / 22	120 / 22
High of transport (cm)			
without conveyor	167	167	167
2 M conveyor	248	248	248
5 M conveyor	252	252	252
Weight (kg)			
without conveyor	365	410	470
2 M conveyor	480	525	585
5 M conveyor	545	590	650

**NEW**

Max. conveyor evacuation height (5 m conveyor = 3 m / 2 m conveyor = 1.45 m)

TCT blade Ø700 mm x 5.0/4.0 Ø 30 mm z= 42 (Ref. CARB 700 SIT/4/5)

Tachometer and hour meter (Ref. CPT HOR SAT)

PTO shaft type 3 (Ref. CAR01)

### ■ Circular tilting saw with conveyor - ST700 series

Circular tilting saw with conveyor, to work with comfort and efficiency.

- Cutting length adjustable from 20 to 50 cm
- 4 m evacuation conveyor
- Conveyor unfolding and speed adjustment hydraulically
- Conveyor with 1 m breaks
- Conveyor controls with pressure release valve
- Stabilization stand



Video on  
[www.a-m-r.fr](http://www.a-m-r.fr)

Circular tilting saw with conveyor	ST700-H	ST700-P
Power supply Direct transmission	Hydraulic Blade driving by PTO shaft /conveyor by hydraulic	PTO Blade and conveyor driving by PTO shaft. The saw is fit with a pump
Serial TCT blade (Ø and boring in mm)	Ø 700 / 30	Ø 700 / 30
Ø max. round log or split log (cm)	26	26
Length of wood (cm)	100	100
Dimension in cm (HxLxW vertical)	transport: 180 x 240 x 150	
Weight (kg)	450	450
Spare TCT blade Ø 700 mm (Ref. LAME WSA)		
PTO shaft type 3 (Ref. CAR01)		
Tilting extension ST700 (Ref. RAL CHE ST700)		
Evacuation conveyor without saw (Ref. BTR4000H/SC) (tractor with single effect valve and free return)		

# Circular tilting saw - WSA series

## ■ Circular tilting saw - WSA series

Saw safely with WSA!

This ultra-robust circular tilting saw meets the European standard EN 1870-6. Ergonomics and easiness to move give optimum work comfort.



WSA-700PE



WSA-700P



Emergency stop lever at PTO



Covered blade easy to access



Log grip system locks the wood while sawing

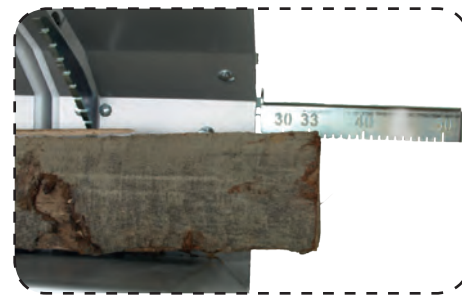

Cutting length indicator

## ■ Circular tilting saw - WSA series

### >Safety

- Fully covered log carriage
- Emergency stop lever at PTO
- Interlock on blade cover on every model (open hood = blade stops)
- Standard EN 1870-6

### >Robustness

- Welded and reinforced chassis

### >Ergonomics

- Gripper holds the wood while sawing
- 3 wheels and handles for easy moving
- Rotational handle for easy cutting process
- Allows several logs to be sawn in same time (when total diameter is under limit)
- Cutting length indicator included
- 3-point hitch for tractor (P and PE models)



WSA-700E



Belt driven

Circular tilting saw	WSA-700E	WSA-700P	WSA-700PE
Power supply	three-phase 400 V 7.5 kW	PTO tractor	three-phase 400 V + PTO tractor
Serial TCT blade Ø and boring (mm)	Ø 700/30	Ø 700/30	Ø 700/30
Ø max. round or split log (cm)	24	24	24
Length of wood (cm)	100	100	100
Dimension in cm (HxLxW vertical)	transport : 113 x 120 x 81 / work : 113 x 150 x 81		
Weight (kg)	157	164	208
Spare TCT blade Ø 700/30 mm (Ref. CARB. 700 WSA)			
PTO shaft type 3 (Ref. CAR01)			

## Circular tilting saw - KWS 550 - 600 series

### ■ Circular tilting saw - KWS

With their blades from 550 and 600 mm, KWS saws work with robustness and comfort.

- Robust building : frame with welded tubes
- Easy to use with stable frame and large wheels
- Chrome or TCT blade included
- Powder coated
- Transport handle
- Serial cutting length indicator
- Serial grip handle
- Option tilting extension

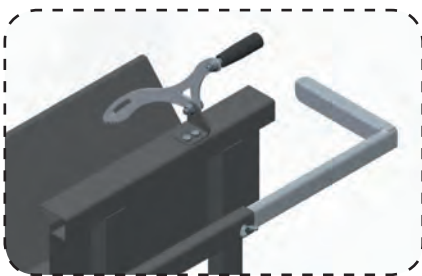

Serial cutting length indicator and grip handle



KWS 550



TCT blade

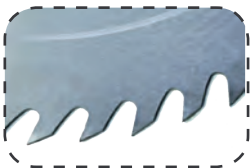

Chrome blade

Circular tilting saw with chrome blade with TCT blade	KWS 550	KWS 600
Power supply	single-phased	three-phase
Direct transmission	230 V 3 kW	400 V 4.2 kW
Blade Ø and boring (mm)	Ø 550 / 30	Ø 600 / 30
Blade rotation (t/min)	2810	1450
Height of work (cm)	70	70
Cut per turn (cm)	20	22
Weight (kg)	88	88
TCT blade Ø 550 mm or Ø 600 mm (Ref. CARB 550/CARB 600)		
Chrome blade Ø 600 mm (Ref. CHRO 600)		
Tilting extension for KWS 550/600 and WKS 650/700		
400 V female plug (Ref. PRI F16)		

**NEW**

**NEW RANGE WKS  
More safety !**



# Circular tilting saw - WKS 650 - 700 series

## ■ Circular tilting saw - WKS series

With their blades from 650 and 700 mm, WKS saws work with robustness and comfort.

- Robust building : frame with welded tubes
- Easy to use with stable frame and large wheels
- Chrome or TCT blade included
- Powder coated
- Transport handle
- Serial cutting length indicator
- Serial grip handle
- Option tilting extension

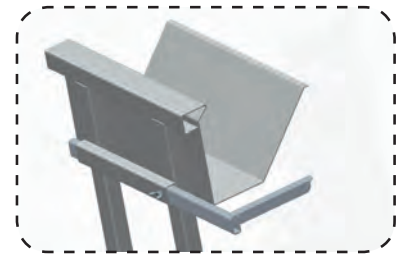

Serial cutting length indicator



WKS 700Z with option tilting extension

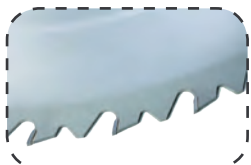

TCT blade

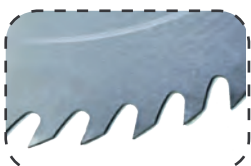

Chrome blade

Circular tilting saw with chrome blade with TCT blade	WKS 650	WKS 700	WKS 700Z
Power supply	single-phased	three-phase	PTO tractor
Direct transmission	230 V 3.5 kW	400 V 5.5 kW	
Blade Ø and boring (mm)	Ø 650 / 30	Ø 700 / 30	Ø 700 / 30
Blade rotation (t/min)	1450	1450	1450
Height of work (cm)	70	70	70
Cut per turn (cm)	24	26	26
Weight (kg)	120	120	120
TCT Blade Ø 650 mm (Ref. CARB 650)			
TCT blade Ø 700 mm (Ref. CARB 700)			
Chrome blade Ø 650 mm (Ref. CHRO 650)			
Chrome blade Ø 700 mm (Ref. CHRO 700)			
PTO shaft type 3 (Ref. CAR01)			
Tilting extension for KWS 550/600 et WKS 650/700			
400 V female plug (Ref. PRI F16)			

### ■ Circular sliding table saw - KRTS series

With blade diameter from 650 to 700 mm, KRTS saws are ideal for simple and ergonomics working on table.

- Robust building : frame with welded tubes
- Undervoltage switch breaker and phase inverter
- Easy to use with stable frame and large wheels
- Mobile table mounted on bearings
- Chrome steel blade included
- Powder coated



KRTS 650



KRTS 700Z



KWTS 700 with sliding table and tilting combined available. CONTACT US

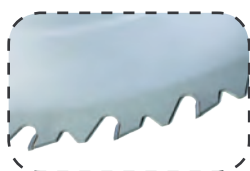

TCT blade

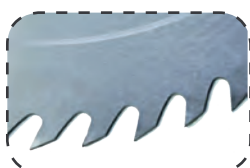

Chrome blade

Circular sliding table saw with chrome blade with TCT blade	KRTS 650	KRTS 700	KRTS 700Z
---	----------	----------	-----------

Power supply	single-phased	three-phase	PTO tractor
Direct transmission	230 V 3.5 kW	400 V 5.5 kW	
Blade (mm)	Ø 650	Ø 700	Ø 700
Blade rotation (tr/min)	1550	1450	1450
Height of work (cm)	84	84	84
Cut per turn (cm)	20.5	20.5	20.5
Weight (kg)	140	140	140

TCT blade Ø 650 mm (Ref. CARB 650)

TCT blade Ø 700 mm (Ref. CARB 700)

Chrome blade Ø 650 mm (Ref. CHRO 650)

Chrome blade Ø 700 mm (Ref. CHRO 700)

PTO shaft type 3 (Ref. CAR01)

400 V female plug (Ref. PRI F16)



## Band-saw - RB series

### ■ Band-saw - RB series

3 flywheel sizes for this band-saw, working with precision and robustness.

- Cutting precision with double blade brass guiding system (up and down)
- Cast iron flywheel for better cut line
- Rubber seal without glue (easily replaceable after usury)
- All PTO driven models are equipped with a safety lever to release
- Blade included
- Belt driven
- Blade tension indicator

*Optional band-saw evacuation conveyor.  
4 m for 3-point hitch*



RB700

Band-saw	RB 500M	RB 500T	RB 600M	RB 600T	RB 600P	RB600PEM	RB600PET	RB 700T	RB 700P	RB 700PET
Power supply	single-phased 230V 2.2kW	three-phase 400 V 3 kW	single-phased 230V 2.2kW	three-phase 400 V 3 kW	PTO tractor	PTO + single-phased 230V	PTO + three-phase 400 V	three-phase 400 V 3 kW	PTO tractor	PTO + three-phase 400 V 3 kW
Ø flywheel (mm)	500	500	600	600	600	600	600	700	700	700
Height/width of cut (cm)	31,5/48	31,5/48	37,5/58	37,5/58	37,5/58	37,5/58	37,5/58	44/68	44/68	44/68
Dimension of table (cm)	90x76	90x76	100x76	100x76	100x76	100x76	100x76	110x76	110x76	110x76
Dimension (HxLxW cm)	219x110x76	219x110x76	229x120x76	229x120x76	229x120x76	229x120x76	229x120x76	255x132x88	255x132x88	255x132x88
Weight (kg)	208	208	257	257	257	280	280	352	354	382
Guidance trolley (Ref. CHARIOT SR)										
Blade for band-saw 500 (30x0.6 lg 3890) (Ref. SR500)										
Blade for band-saw 600 (30x0.6 lg 4620) (Ref. SR600)										
Blade for band-saw 700 (30x0.6 lg 5200) (Ref. SR700)										
PTO shaft type 3 (Ref. CAR01)										
Evacuation conveyor (hydraulic driving) (Ref. BTR4000 H/SR) (tractor with single effect valve and free return required)										

### ■ 5 M independant conveyor - TMB

Independant conveyor, ideal to transport wood or other materials.

- Horizontal folding of the conveyor for a safe transport
- Draw bar for the trailer coupling
- Telescopic conveyor with safety grid and individual sections (changable separately in case of defect)

**NEW**



Draw bar for trailer coupling

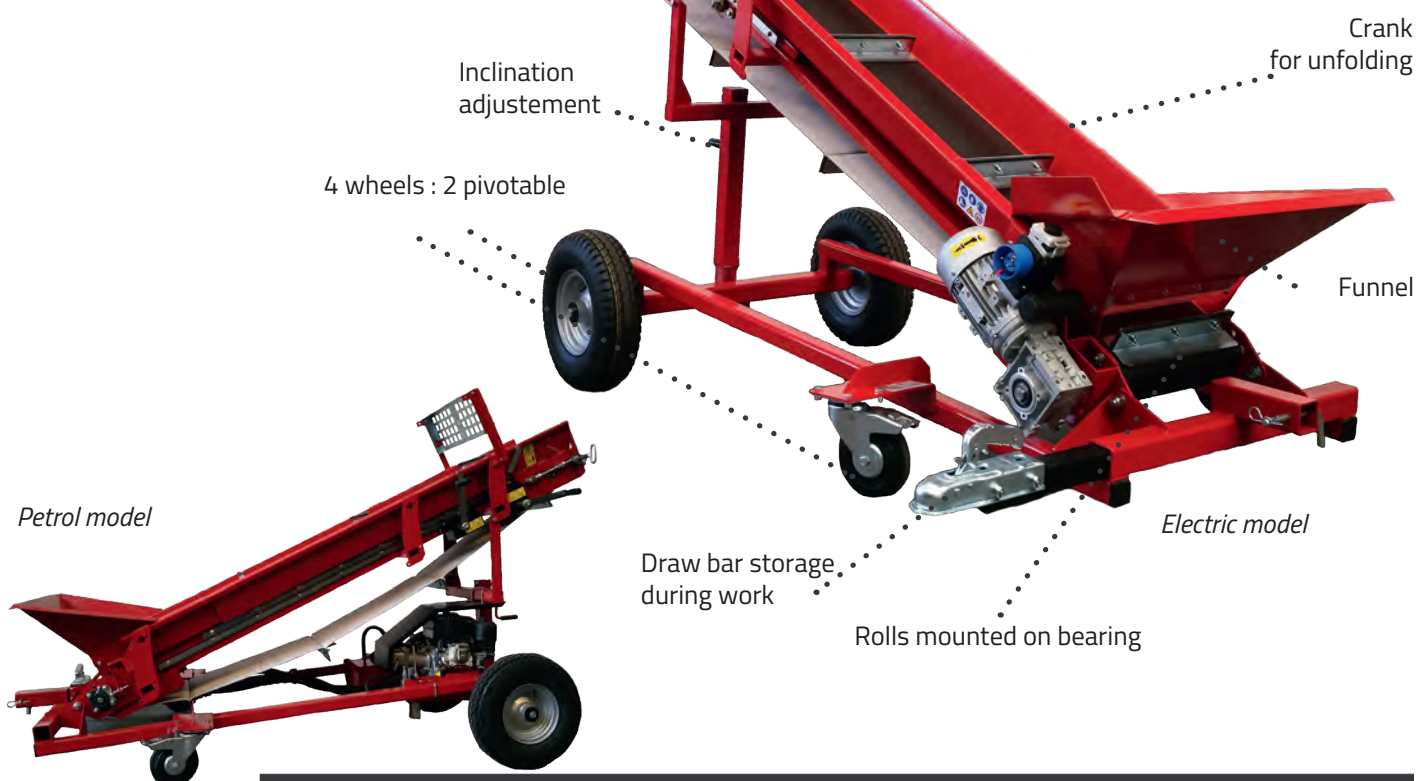

Conveyor	Electric : single or three phase	Hydraulic tractor	Petrol engine
Width (cm) / length (m)	35 / 5	35 / 5	35 / 5
Conveyor speed (m/s)	0.6	depending from tractor output	0.4 - 0.9
Engine power	0.75 kW	0.75 kW	4 HP
Height of loading / unloading	60 / Min: 1.7 - Max: 3	60 / Min: 1.7 - Max: 3	60 / Min: 1.7 - Max: 3
Dimension of the funnel (cm)	70 x 40	70 x 40	70 x 40
Dimension of transport (HxLxW cm)	100 x 260 x 120		
Weight (kg)	290	290	325

Video on  
[www.a-m-r.fr](http://www.a-m-r.fr)

# More about firewood

## The different woods and their burning characteristics

### PINE AND SPRUCE

They are easy to light and wood chips are therefore ideal for lighting a fire. The soft wood tends to make sparks. The molten resin blocks the wood's grain, moisture in the log turns to steam and under pressure bursts the log.

### BEECH

Develops a lot of embers and therefore, equal and sustainable heat. Beech flames are beautiful, burning essentially without sparks. Suitable for all types of log burners, particularly those with a window.

### OAK

Has high calorific value and burns for a long time. Ideal for log burners used as a heating medium (e.g. Tiled stove).

### ASH OR MAPLE

Hardwoods that have a comparable combustion process to Beech.

### BIRCH

The ideal wood for fireplaces. Does not spark and produces blue flames and scented fragrances. Its white bark makes for pleasant decoration.

### POPLAR AND WILLOW

This wood burns very quickly and is therefore not very suitable for firewood. Can optionally be used as a 'summer wood' for a fireplace when it is not desired for energy performance.

## UNITS SALES

Firewood is usually offers :

### IN METRE CUBE :

1 x 1 x 1 m of pure wood without cavity

### IN STERE :

1 x 1 x 1 m of stacked wood with cavities

### STERE BULK :

1 x 1 x 1 m bulk timber with cavities

### WEIGHT :

in kilograms (kg) with the following data; Wood type and moisture content.

To avoid misunderstandings, it is recommended to seek accurate information on the timber when buying, because depending on the type, even the energy content is varied.

### Reference value for the cubic meter and stere

The dimensions of the wood in a cubic meter of firewood depend on the shape and wood lopping, diameter and length of the log and also the care when cutting.

Since wood fuel is not a homogeneous raw material, the following table consists only of average conversions for different assortments.

Round wood in m <sup>3</sup>	Storage in stere		Slice 33 cm piled up m <sup>3</sup> in m <sup>3</sup>	Quarters of 33 cm jumbled m <sup>3</sup>
	not split	split		
1	1.4	1.6	1.4	Spruce : 2.2 Beech : 2
0.7	1	1.2	1	Spruce : 1.6 Beech : 1.4
0.4	0.6	0.7	0.6	1

# SKIDDING RANGE



## ■ Hydraulic skidding grapple

The skidding grapple is made for lifting and moving timber quickly and easily.

With the toothed bar on the 3-point hitch, the clamp can move and maintain properly entire timbers, or even much shorter.

The big advantage is that it requires only a low tractor power and does not need to get off the tractor to handle.

### RZ 110 model

- Recommended for tractor until 30 HP
- Double acting cylinder
- Rotating angle of 80° (left and right)
- Good tensioning capacity
- Easy adaptation on the tractor 3 point hitch
- Cat. I
- **Tractor with double effect valve required**



RZ 110

### RZ 165 model

The skidding grapple is made for lifting and moving one heavy timber, or several at the same time.

The clamping capacity is expected to provide a safe work especially when you move stacked wood or branches.

The notched arms have specific shape to prevent the wood from slipping.

- Recommended for tractor from 60 to 120 HP
- Double acting cylinder
- Rotating angle of 82° (left and right)
- Good tensioning capacity
- Easy adaptation on the tractor 3-point hitch
- Cat. II
- **Tractor with double effect valve required**

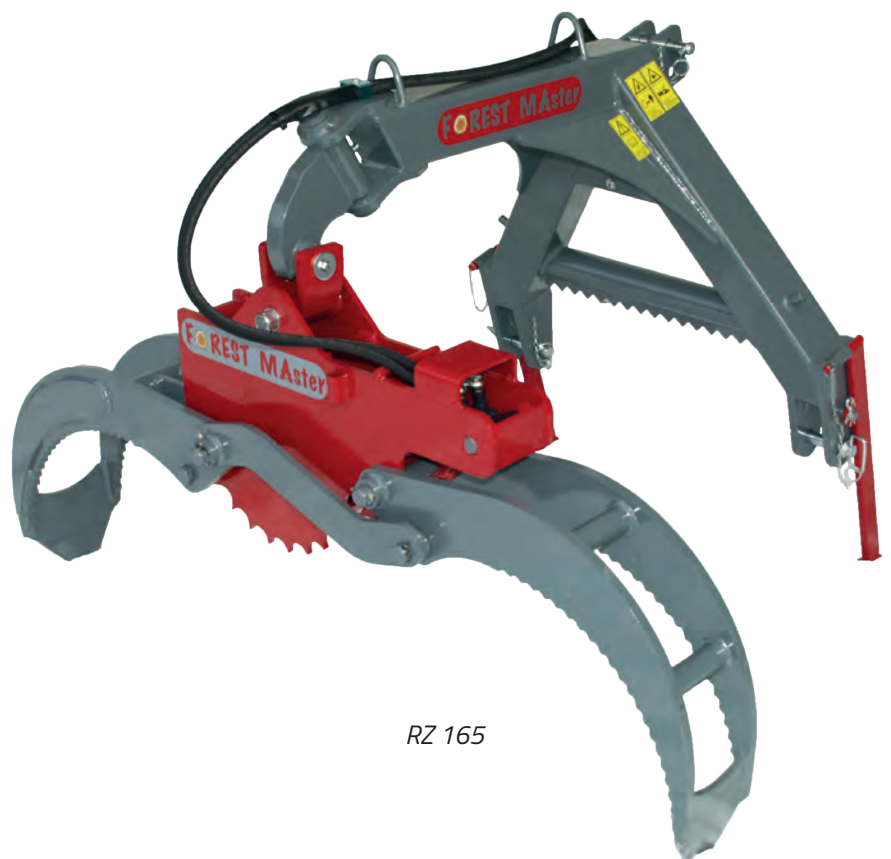

RZ 165

### ■ RZ165-R model

The skidding grapple rotator allows to manipulate logs with precision, even in a slope.

- Recommended for tractor from 60 to 120 HP
- Double acting cylinder
- Continuous rotation
- Good tensioning capacity
- Easy adaptation on the tractor 3 point hitch
- Cat. II
- **Tractor with double effect valve required**



RZ 165-R



Adaptor for front loader  
(euro)

#### Grapple RZ 110

#### Grapple RZ 165

#### Grapple RZ 165-R 4,5 to / with rotator 4,5 to (winch not included)

#### Grapple RZ 165-R 6 to / with rotator 6 to (winch not included)

	RZ 110	RZ 165
Tightening power (to)	6	9
Max. opening (cm)	110	170
Min. opening (cm)	6	11
Closed length (cm)	100	122
Ø max. of timber (cm)	45	70
Ø min. of timber (cm)	7	12
Max. pressure (bar)	180	180
Weight (kg)	140	295
Adaptor for front loader (euro) (Ref. ADAT RZ110/165 -F)		

## ■ RZ165-F Model

This new skidding grapple with radio remote control winch makes you reach even more easily timbers to move them.

Work quicker and safely.

- Recommended for tractor from 60 to 120 HP
- Double acting cylinder
- Rotating angle of 82 ° (left and right)
- Good tensioning capacity
- Easy adaptation on the tractor 3 point hitch
- Cat. II
- **Tractor with double effect valve required**

## ■ Radio remote control winch FW 1400-R

- Cable 35m / 6mm
- Works with radio remote control
- Hydraulic supply
- Traction power: 1400 kg
- **Tractor with single effect valve required**



RZ 165-F



Serial storage bar on all model RZ 165



Winch on RZ 165-F

### Skidding grapple RZ 165-F (with radio remote control winch FW 1400-R)

Tightening power (to)	9
Max. opening (cm)	170
Min. opening (cm)	11
Closed length (cm)	122
Ø max. of timber	70
Ø min. of timber	12
Max. pressure (bar)	180
Cable	6 mm / 35 m
Traction power (kg)	1400
Cable speed (m/s)	0.38
Weight (kg)	330
Radio remote control winch FW1400- R for adaptation on RZ 165 (Ref. FN1400R) (not compatible with RZ 165-R 4.5 and RZ165-R6)	
Adaptator for „euro“ front loader (Ref. ADAPT RZ 110/165-F)	

### Radio remote control B&B

- New shape can be worn closer to the body so as not to restrict movement
- Large distance capacity
- Large display and easy to use, even with thick gloves
- An anti involuntary action protection (eg branches) to ensure maximum safety
- Multiple operating positions from the hip, abdomen or chest

#### F10 model

4 functions (6 functions with MAS option) for electro-hydraulic winch with single drum (F10 ET model).

6 functions (8 functions with MAS option) for electro-hydraulic winch with double drum (F10 DT model).

Switch control by levers.

1. Tighten the cable (x2 with double drum)
2. Release the cable (x2 with double drum)
- 3/4. Gas + / -
- 5/6. Switching on / off the tractor (MAS option)

**Included** charger, receiver, transmitter, accu and belt

**Not included** accelerator cylinder for Gas +/-

#### F6 model

4 functions for electro-hydraulic winch with single drum.

Switch control by button.

1. Tighten the cable
2. Release the cable
- 3/4. Gas + / -

**Included** receiver, transmitter, accu and belt

**Not included** accelerator cylinder for Gas +/- and charger

Please tell us which winch brand and model you have when you order.

F6 ET



Receiver

Video on  
[www.a-m-r.fr](http://www.a-m-r.fr)

F10 ET



F10 DT



#### Radio remote control for winch with single drum

Radio remote control 4 functions F10 ET, for single winch with gaz+ /gaz-\*

Radio remote control 6 functions F10 ET/MAS, for single winch with gaz+/gaz- \* and function on/off the tractor

Radio remote control 4 functions F6 ET, for single winch with gaz+/gaz-\*

#### Radio remote control for winch with double drum

Radio remote control 6 fonctions F10 DT, for double winch with gaz +/gaz-\*

Radio remote control 8 functions F10 DT/MAS, for double winch with gaz+/gaz- \* and function on/off the tractor

\*without accelerator cylinder

#### Accessories

Support for transmitter F 10/F6 (Ref. SUPP F6/F10)

Charger 230 V (Ref. CHARG B&B)  
4 rechargeables accu Sanyo AA / electric 230 V

Charger on cigarette lighter 12 V (Ref. CHARG AC B&B) 2 rechargeables accu AA to charge on the 12 V of the cigarette lighter

Replacement battery Sanyo eneloop AA (Ref. BAT. B&B) 4 accu Sanyo eneloop AA 1,2 V in a plastic box

Accelerator cylinder p. 74



## Tractor inclination control device

### ■ Tractor inclination control device

This patented device surveys the inclination of tractor and stops tightening of winch as soon as a risk of reverse appears.

Only available on electro-hydraulic winch with radio remote control.

> 3 inclination tolerances available, to select :

- Safety : 13° / 22° (left/right - front/back)
- Standard : 15° / 25° (left/right - front/back)
- Large : 17° / 28° (left/right - front/back)

> Calibration of the zero point

> Led display of functions « on » and « out of tolerance »

> Test mode for functional check

> Possible to by pass the control device

**NEW**  
for F10

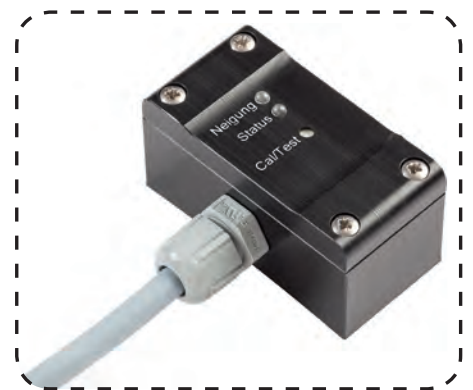

NÜ 2515 GU



NÜ 2515 GU N



NU 2515 GU  
with radio F10

NU 2515 GU N  
Adaptable on TAJFUN winch with plug  
connection.

### ■ Radio remote control ELCA - 4 functions

Radio remote control 4 functions for electro-hydraulic winch for single drum.

1. Tighten the cable
2. Release the cable
- 3/4. Gas + / -

Included charger, receiver, transmitter and belt



#### Radio remote control for single winch

Radio remote control 4 functions ELCA, for single winch (Ref. RAD. ELCA)



### ■ Accelerator cylinder WARNER

Control motor for continuous control of gas for tractors and farming machines to mechanical throttle. 12 V.

- Compact sealed aluminium housing
- Stroke 50 mm
- Power : 440 N
- Max static power : 1350 N
- Speed 11 mm/s
- Operating temperature -25 ° C + 65 ° C
- Protection against overload
- IP65 protection
- Dimensions (WxHxD) : 174x74x38 mm
- Current consumption max 3 A at 12 V



Example :



Tractors Fendt / Valtra

Accelerator cylinder (Warner) 12 V  
(Ref. VER. ACCEL)

# HANDLING RANGE



### ■ Bundler for 1 stere

Season your wood in a cubic meter bundler (at 1m) or half a cubic meter (50 cm). Easy to use and comfort with practice swing, time saving. Robust construction ensures a long service life. Pivoting mechanism ensures ergonomic work.

#### Strengths :

- Suitable for wood lengths of 33, 50 and 100 cm
- Easy to pivot (hydraulic/mechanical)
- With string or polyester strips
- Basket diameter : 120 cm
- On 3-point hitch or hitch + euro linkage for front loader
- Ergonomic work height
- Robust and durable



*Bundler with polyester strips  
mechanical pivoting  
on 3-points hitch + euro  
linkage for front loader*



Video on  
[www.a-m-r.fr](http://www.a-m-r.fr)

## Evolute bundler



Mechanical pivoting



Hydraulic pivoting (left or right)



Hydraulic tension system  
(left or right)



Accessories kit for  
polyester strips  
bundler

### Polyester bundler with mechanical pivoting

Polyester bundler with 3-point hitch

Polyester bundler with 3-point hitch + euro front loader

### String bundler with mechanical pivoting

String bundler with mechanical tension and 3-point hitch

String bundler with mechanical tension and 3-point hitch + euro front loader

NEW

String bundler with hydraulic tension and 3-point hitch

NEW

String bundler with hydraulic tension and 3-point hitch + euro front loader

NEW

### Evolute bundler - add functions

Option hydraulic pivoting for all models

Option euro front loader

Option hydraulic string tension (2 spool supports included)

Option mechanical string tension (2 spool supports included)



Intermediate support for splitter and bundler

Intermediate support for splitter and bundler (Ref. SIFF)  
(wide-angle PTO shaft recommended)

Wide-angle PTO shaft

Accessories kit for polyester strips bundler (Ref. KIT POLY FAG.)  
(500 m of polyester stripes 19 mm, reel, 1000 staples and clamp)

Reel with brake for polyester strips (Ref. DEROUL POLY.)

Clamp for polyester strips (Ref. PINCE BAN19)

Polyester stripes 500 m / 19 mm (750 daN) (Ref. BANDE POLY FAG)  
when ordering, specify mandrel Ø75 or Ø200

Staples 1000 pieces / 19 mm (Ref. AGRA 19)

String spool (250 m 8 threads, 1040 daN)  
String spool (190 m 10 threads, 1250 daN)

### ■ Arm grapple

Robust arm grapples for intensive handling. They can be fitted to front loader with standard EURO hitch and need hydraulic supply from tractor (double effect required).

Grapples are made of hardox steel for maximum tensile strength and an extended lifetime.

This steel also helps to lighten the grapple.

- Continuous rotation
- Rotator 3 t / 6 fins
- Great precision of movement
- Significant grip strength in order to grab and maintain logs of all sizes
- Grapple lightness increases its payload
- All axes are oversized to absorb all charges
- Optionally, it is possible to adapt the arm on the 3-point hitch for tractor / JCB / Manitou



Arm grapple with rotator and serial euro front loader	KG180 R	KG210 R
Loading capacity (to)	1	1
Useful capacity (m <sup>2</sup> )	0.18	0.21
Max. opening (cm)	110	130
Steel	Hardox	Hardox
Power at arm's end (kg)	700	700
Pressure recommended (bar)	150-215	150-215
Weight (kg)	250	280

Supplement 3-point adaptor
Supplement Manitou adaptor
Supplement JCB adaptor



## Rotator FHR 3000 L with shaft

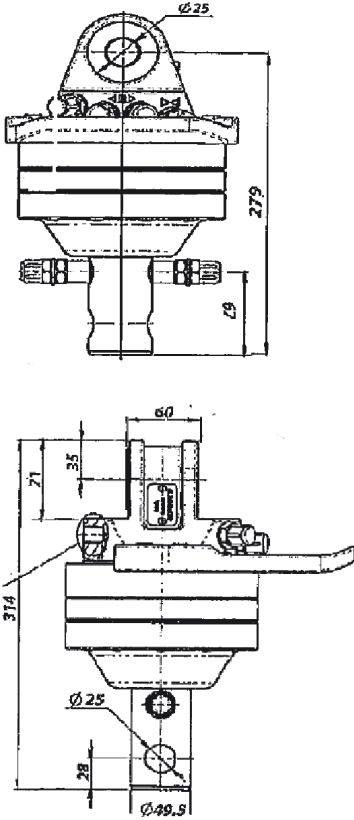

FHR 3000L  
Rotator with shaft



GR603  
Rotator with flange

## Rotator GR 603 with flange

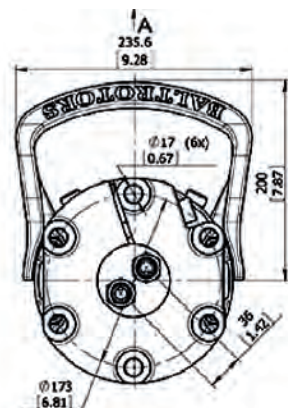
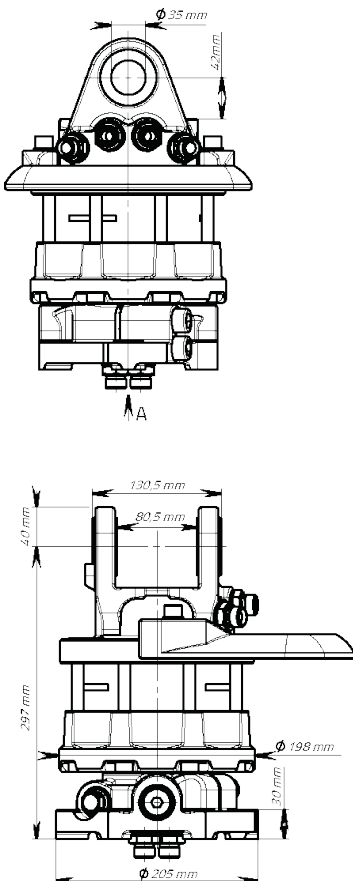

Rotator	FHR 3000 L	GR 603
Max axial load static (to)	3	6
Ø shaft or flange (mm)	49.5	173
Ø hole of shaft or flange (mm)	25	6x17
Max working pressure (bar):		
- Rotator	250	250
- Open	200	200
- Closed	300	300
Weight (kg)	18	43



<b>Grapple (without rotator)</b>	KG180	KG210	KG225 PRO	KG300 PRO	KG335 PRO
Rotator recommended (not included) (to)	3	3	6	6	6
Max. opening (cm)	110	130	140	155	160
Max. capacity (cm <sup>3</sup> )	0.18	0.21	0.25	0.30	0.35
Max. loading (to)	1	1	2.5	3	3.5
Steel	Hardox	Hardox	Hardox reinforced	Hardox reinforced	Hardox reinforced
Power at arm's end (kg)	700	700	700	700	700
Pressure recommended (bar)	150-215	150-215	150-215	150-215	150-215
Adaptation	shaft Ø 50 mm	shaft Ø 50 mm	flange 6 holes Ø 173 mm	flange 6 holes Ø 173 mm	flange 6 holes Ø 173 mm
Weight (kg)	79	83	141	191	248

When ordering a grapple with rotator, add hoses kit :

FLX00948 for KG180 / KG210

FLX01002 + VIS10009 for KG 225

FLX01016 + VIS10010 for KG300 / KG335



# Timber claw

## ■ Timber claw

The timber claw is a powerful and robust tool. It has a massive but flexible structure to avoid twisting in case of heavy loads.

It is designed to lift, move and load timbers or poles, heavy-pipes and round bales.

- Load capacity of 3 to 6 tons depending on model
- Large opening angle
- Protected cylinder, hydraulics and hoses
- The top claw completely closes on the one below to handle even the thinnest material.
- Compatible : small tractor with front loader
- Hoses included
- **Tractor with double effect valve required**

6 Tons model  
GRI06

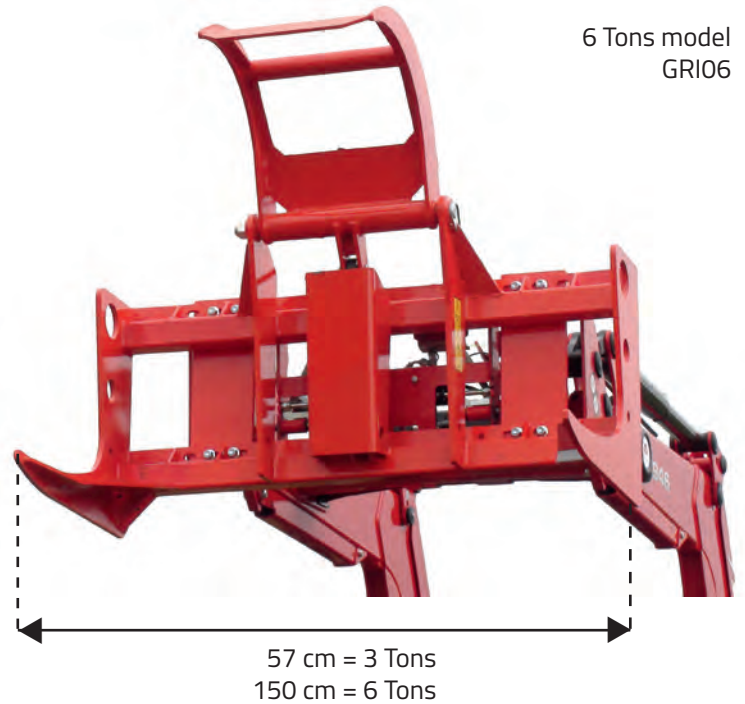

Timber claw with serial euro linkage	GRI03	GRI06
Max. loading (to)	3	6
Cylinder	hydraulic	hydraulic
Euro support	standard	standrad
Max. opening (cm)	100	100
Fork width (cm)	57	150
Weight (kg)	185	250
Supplement 3-point adaptator		
Supplement Manitou adaptator		
Supplement JCB adaptator		



### ■ Timber blade

The blade is of a particularly robust design. The hydraulic cylinder and the clamp have been designed for high loads. Its particular shape allows stability of any timber.

- Suitable for all front loaders with euro linkage
- Hoses included
- Tractor with double effect valve required



**Timber blade PZ 1400 E** with euro linkage and hydraulic arm

**Timber blade PZ 1400 D** with 3-point linkage cat. II and hydraulic arm

Max. loading (to)	2.4
Max. opening (cm)	90
Width (cm)	140
Max. pressure (bar)	180
Weight (kg)	210



# FARMING RANGE



### ■ Tilting universal bucket

Universal bucket on 3-point hitch tractor, with a tilting system for easy use. Wide opening angle in tilted position.

- Mechanical or hydraulic tilting
- High quality dumpster in 5mm thick sheet
- Optional side rail
- Cat. I and II
- Maximal loading : 900 kg
- **Tractor with double effect valve required for hydraulic model**

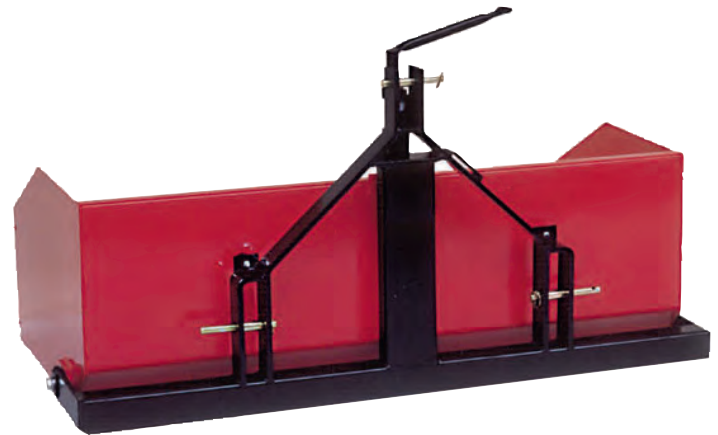

*Mechanical bucket*



*Mechanical bucket*

Specific articulation point of tilting system, making linkage more resistant.



*Mechanical bucket with optional side rail*

**STEEL  
THICKNESS  
5 mm**



Bucket	B100	B125	B150	B175	B200	B225
<b>Hydraulic</b>						
<b>Mechanical</b>						
Width (cm)	100	125	150	175	200	225
Dimension (LxWxHcm)	100x90x60	125x90x60	150x90x60	175x90x60	200x90x60	225x90x60
Max. capacity (m <sup>3</sup> )	0.5	0.6	0.7	0.9	1	1.1
Max. loading (kg)	400	496	603	704	800	904
Weight (kg)	165	180	200	225	240	255
Option side rail	Ref. RID100	Ref. RID125	Ref. RID150	Ref. RID175	Ref. RID200	Ref. RID225
Hardox blade (per meter)	Ref. HDX					



■ Stone/wood fork

Stone forks are available in 3 widths (1.5 m / 2 m / 2.35 m), all made of quality steel for maximum resistance and durability.

High capacity in terms of stone volume to reduce the number of loading/unloading operations. The down part is cambered to avoid involuntary unloading. Specially made for carrying stones, this fork can also carry wood. Euro linkage included.

Stone/wood fork	1.5 M Ref. FOU PIE1.5	2 M Ref. FOU PIE 2.0	2.35 M Ref. FOU PIE 2.35
Width (cm)	150	200	235
Max. capacity (m <sup>3</sup> )	0.9	1.2	1.49
Standard	euro linkage	euro linkage	euro linkage
Weight (kg)	215	265	405
Supplement 3-points tractor adapter			
Supplement Manitou adapter			
Supplement JCB adapter			



### ■ TM/TL Series

This machine can mulch branches and timbers up to 20 cm with its numerous chopperblades! It can be hitched on a tractor.

- Robust steel design
- Rotor hood hydraulic opening
- Adaptable on 3-point linkage
- Driving : 1 lateral shaft
- Double bottom 2x6 mm (very robust)
- Bearings autocentered and watertight
- Return with freewheel
- Rotor with mobile tools (TM) or fixed widia blade (TL)
- PTO shaft included



Forest mulcher TM  
without guard frame

#### TM model :

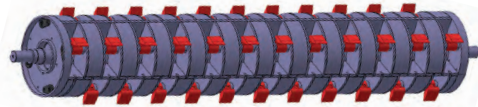

#### TL model :

Rotor with fixed widia blade

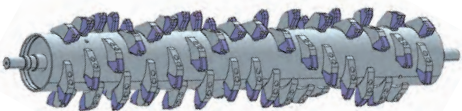

Video on  
[www.a-m-r.fr](http://www.a-m-r.fr)

Forest mulcher TM	TM 1400	TM 1600	TM 1800	TM 2000
Forest mulcher TL	TL 1400	TL 1600	TL 1800	TL 2000
Working width (cm)	140	160	180	200
Total width (cm)	170	192	212	234
Weight (kg)	1060	1110	1160	1210
Number of hammer (TM)	24	28	32	36
Min. tractor power	80 HP / 60 kW	80 HP / 60 kW	80 HP / 60 kW	80 HP / 60 kW
Max. tractor power	100 HP / 74 kW	100 HP / 74kW	130 HP / 97 kW	130 HP / 97 kW
Dimension (LxWxH) cm	170x112x112	192x112x112	212x112x112	234x112x112
Guard frame (mechanical ajustement)	Ref. BA 1400	Ref. BA 1600	Ref. BA 1800	Ref. BA 2000
TM - spare hammers (Ref. HAC BROY)				
TL - spare widia blade				

## ■ TF/DT Series

This machine can mulch branches and timbers up to 30 cm with its numerous chopperblades! It can be hitched on a tractor.

- Robust steel design
- Rotor hood hydraulic opening
- Adaptable on 3-point linkage
- Driving : 2 lateral shafts
- Gearbox with flywheel
- Double bottom 2x8 mm (very robust)
- Return with freewheel
- Rotor with mobile hammers
- PTO shaft included



Forest mulcher TF/DT 2500 with guard frame

### Standard :

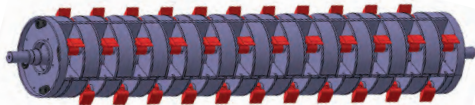

### On demand :

Rotor with fixed wide blade

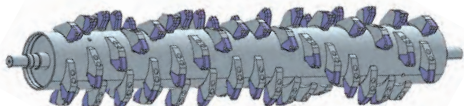

**Video on**  
[www.a-m-r.fr](http://www.a-m-r.fr)

Forest mulcher	TF/DT 2100	TF/DT 2500
Working width (cm)	210	250
Total width (cm)	250	292
Weight (kg)	2350	2520
Number of hammer	37	45
Min. tractor power	130 HP / 97 kW	130 HP / 97 kW
Max. tractor power	200 HP / 150 kW	200 HP / 150 kW
Dimension (LxWxH) cm	250x145x120	292x145x120
Guard frame (hydraulic adjustment)	Ref. BA TF/DT 2100	Ref. BA TF/DT 2500
Spare hammers (Ref. HAC BROY)		
Spare wide blade		

# ACCESSORIES





## Return pulley and polyester strap

### ■ Opening return pulley

- The valve mechanism allows an easy cable insertion
- Rotating high-resistance hook
- With latch hook
- Only for steel cable



Return pulley with valve	80 kN Ref. PRO 80	140 kN Ref. PRO 140
--------------------------	----------------------	------------------------

Ø pulley (mm)	140	140
Ø cable (mm)	12	14
Weight (kg)	6.5	8.5

### ■ Aluminium return pulley

- Suitable for steel cables and polyester straps
- Rotating lock
- With ball bearing
- Lightness from aluminium

Aluminium return pulley	110 kN Ref. PRAL110	150 kN Ref. PRAL150	170 kN Ref. PRAL170
-------------------------	------------------------	------------------------	------------------------

Ø and width of pulley (mm)	158-35	198-42	198-42
Ø cable (mm)	14	16	16
Weight (kg)	2.4	3.9	5.1



### ■ Polyester strap

- Reinforced curls ends according to EN 1492-1
- Low friction
- No swelling in high humidity
- Polyester doubled for maximum strength

#### Polyester strip with 2 curve ends

	Colour code	Width	Length
Ref. SAN 3/60	green	60 mm	3 m
Ref. SAN 3/90	yellow	90 mm	3 m
Ref. SAN 3/120	grey	120 mm	3 m

#### Indications of resistance by the number of stripes and by the colour

Break point coef. 7	Colour code	100%	80%	200%
14 000 kg	green	2000 kg	1600 kg	4000 kg
21 000 kg	yellow	3000 kg	2400 kg	6000 kg
28 000 kg	grey	4000 kg	3200 kg	8000 kg

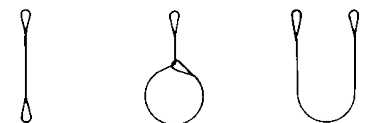

Curve ends

Indication of resistance by the colour

Indication of resistance by the number of stripes

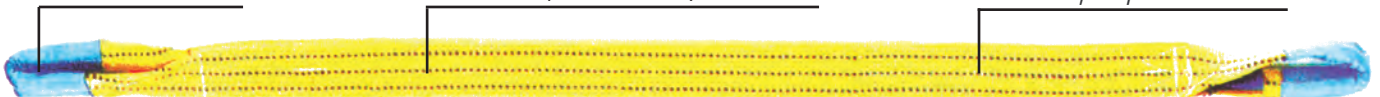

■ **Mobile pulley TAJFUN PS 130**

- Large loading capacity
- Low weight and small size compared to others pulley on market
- «SMART» locking allows quick and easy opening of lateral face of pulley
- High quality materials
- 3 meters long lanyard

**Stowage lanyard**

Specifically adapted to work comfortably with TAJFUN PS 130 mobile pulley and forest winches.

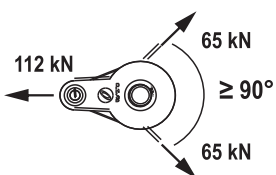
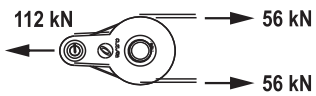
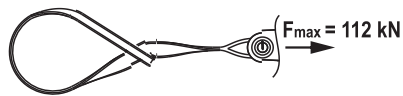
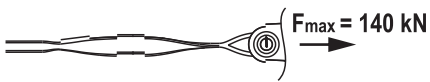

**Mobile pulley, 2.55 kg with 3 M lanyard**  
**Max. loading capacity : 130 kN**  
**Break point : 260 kN**



# Hook

## Chain rope connector Red cat.8



Reference	w mm	For chain	angle	Weight kg	Traction daN
CRO-RCF08R	20	8 mm	45°	0.65	4500
CRO-RCF10R	20	10 mm	45°	0.90	6500

## Blue cat.10



Reference	Dimensions mm		For chain	Weight kg	Traction daN
	w	l			
CRO-RCF08B	20	145	8 mm	0.61	6000
CRO-RCF10B	36	207.5	10 mm	1.38	8500

## Rotating chain rope connector Red cat.8 / Blue cat.10



Reference	w mm	For chain	angle	Weight kg	Traction daN
CRO-RCP08R	20	8 mm	45°	0.68	4500
CRO-RCP08B	20	8 mm	-	0.68	6500

## Sliding hook Cat. 8



Reference	Cable Ømax	Dimensions d	g	g1 min	Weight kg	Traction daN
CRO-CL13R	20	16 mm	25	17	0.69	3000
CRO-CL16R	20	22 mm	26	17	0.97	5000

## Hitting hook



Designation	Weight kg	Traction daN
Hitting hook for log winch Ref.CRO FRAP	0.65	4000

## Blocking sleeve

- For winch cable Ø 10 to 14 mm



Blocking sleeve + corners Ø10/14 mm (Ref. DOU00003)
Choker for winch cable Ø10/14 mm (Ref. CHO00007)

## Choker

- For winch cable

## Sliding cable end



Reference	Cable Ø	Length	Weight kg	Traction daN
EXT00001	8-12 mm	23 cm	1.3	6000

### High quality steel cable

- High strength
- Available diameters : 9, 10, 11, 12, 13 and 14 mm
- Standard assembly : 1x loop + Sliding hook

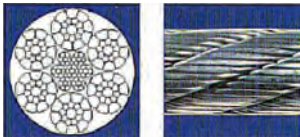

Steel cable (mm)	Ø 9	Ø 10	Ø 11	Ø 12	Ø 13	Ø 14	Ø 16	Ø 18
Break point (kN)	84	101	122	142	170	200	239	297
Ref.	CAB09R	CAB10R	CAB11R	CAB12R	CAB13R	CAB14R	CAB16R	CAB18R
Weight per meter (kg)	0.453	0.543	0.655	0.764	0.881	1.01	1.29	1.59
1x loop + Sliding hook								

### Red skidding chain cat. 8

- Chain with hook and needle



#### Round skidding chain / red cat. 8 + hook + needle (galvanised)

Ø8 mm, Lg 2.5 m (traction : 40 kN / break : 80 kN) (Ref. RR8-2.5)

Ø8 mm, Lg 4 m (traction : 40 kN / break : 80 kN) (Ref. RR8-4)

Ø10 mm, Lg 2.5 m (traction 63 kN / break : 126 kN) (Ref. RR10-2.5)

#### Square skidding chain / red cat. 8 + hook + needle (painted)

Ø8 mm, Lg 2.5 m (traction : 45 kN / break : 90 kN) (Ref. CR8-2.5)

Ø10 mm, Lg 2.5 m (traction : 63 kN / break : 126 kN) (Ref. CR10-2.5)

#### Round skidding chain / blue cat. 10 + hook + needle (galvanised)

Ø8 mm, Lg 2.5 m (traction : 50 kN / break : 100 kN) (Ref. RB8-2.5)

Ø8 mm, Lg 4 m (traction : 50 kN / break : 100 kN) (Ref. RB8-4)

Ø10 mm, Lg 2.5 m (traction : 80 kN / break : 160 kN) (Ref. RB10-2.5)

#### Square skidding chain / blue cat. 10 + hook + needle (painted)

Ø8 mm, Lg 2.5 m (traction : 60 kN / break : 120 kN) (Ref. CB8-2.5)

Ø10 mm, Lg 2.5 m (traction : 85 kN / break : 170 kN) (Ref. CB10-2.5)

### Blue skidding chain cat. 10

- Chain with hook and needle



### Hook for skidding chain

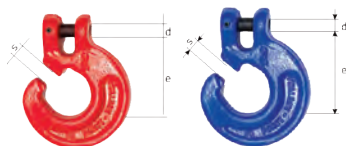

Rouge : cat. 8 / Bleu : cat.10

Reference	d	Dimension e mm	For chain	s	Weight kg	Traction daN
CRO-CD08R	10.0	59.0	8 mm	10	0.38	6000
CRO-CD10R	12.5	80.8	10 mm	12	0.76	8500
CRO-CD08B	10.0	59.0	8 mm	10	0.38	6000
CRO-CD10B	12.5	80.8	10 mm	12	0.76	8500

### Parallel hook with eyelet

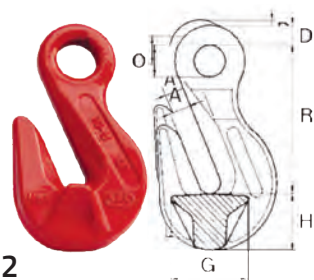

For chain Ø mm	Reference	Dimensions mm						Weight kg	Traction daN
		A	D	O	R	G	H		
8	CRO-A008R	10	10	16	60	30	24	0.23	4000
10	CRO-A010R	13	11	21	80	44	31	0.59	6300

## Moss remover and wood storing

### Small moss remover

- Fixed on a small tractor back, to remove moss and roots from grass surface
- 2 rows of 10 shifted peaks for scarification on a 1m width
- Central part dimension : 1000 x 235 mm
- Ballasting weight : min. 30 kg recommended



*Small moss remover*

Small moss remover 1000 x 235 mm (Ref. EMOUSSEUR P)

### Large moss remover

- Fixed on a tractor back, to remove moss and roots from grass surface
- 4 rows of 20 shifted peaks for scarification on a 2m width
- Central part dimension: 2000 x 590 mm
- Ballasting weight : min. 30 kg recommended



*Large moss remover*

Large moss remover 2000 x 590 mm (Ref. EMOUSSEUR G)

### Plastic frame for wood filling

- Exists in 40 and 60 L
- Maximum wood length max. 30 cm



Frame 40 L for wood

Ref. CADRE 40

Frame 60 L for wood

Ref. CADRE 60

Bag 40 l, 50 x 85 cm with locking

Ref. FILET 40-1

Bag 60 l, 60 x 85 cm with locking

Rf. FILET 60

### Steel articulated frame for wood storage

- Accessory : filet



Steel articulated frame for filet of 1000 L  
(Ref. CADRE 1000)

Filet 1000 L capacity

194 x 140 cm, for euro pallet with UV protection

Ref. BIG 1000

**OCHSENKOPF sapie**

- Ergonomic use
- High durability



Sapie OX 173 E-0500

Length 380 mm, weight 0.7 kg

Ref. SAP 380

Sapie OX 173 H-0580

Length 800 mm, weight 1.1 kg

Ref. SAP 800

Slaughter lever OX 58 -0800

Length 800 mm, weight 2.8 kg

Ref. LEV 800

Slaughter lever OX 58 -1200

Length 1.300 mm, weight 3.6 kg

Ref. LEV 1300

**OCHSENKOPF Slaughter lever**

- Powerful, effective and ergonomic
- Forged steel
- Comfortable and non-skid cork handle
- Adjustable hook

**Safety rules :**

- One user at a time
- Maximum load 150 kg at the handle
- In case of damage, the product must be replaced

**Chainsaw support**

- Reversible for right or left-handed
- Adaptable to all chainsaw models
- With wood blocking by lug and claw handle



Chainsaw support  
compatible with all models  
Ref. CHEVALET

**Jack for front wheels mover**

- Maximum diameter 400mm
- Adjustable width
- Lifting capacity : 250 kg maximum

Jack for front wheels mover  
Length 380 mm, weight 0.775 kg  
Ref. CRIC

**Log trolley**

Steel trolley, ideal for storing and transporting wood logs up to a length of 50 cm.

- Elegant wood handle makes moving easy
- Volume : L 42 x W 49 x H 80 cm
- Weight : 32 kg (without wood)
- Solid tyres



**Individual laser cutting is possible from a minimum order quantity of 10 pieces (no extra costs)**



Log trolley











## Products warranty - AMR & partners

### WARRANTY DURATION

- > Log splitter - AMR : 2 years
- > Kindling machine, Kindlet - FUELWOOD : 1 year
- > Grapple and other products - KTS : 1 years
- > Grapple and other products FOREST MASTER : 1 year
- > Quatromat & Solomat - AMR : private : 2 years / professional : 1 year
- > Saw ST700 : 2 years
- > Little circular saw : 2 years
- > Band saw : 1 year
- > Conveyor TMB - AMR : 2 years
- > Forest mulcher - Zanon : 1 year
- > Stones fork - AMR : 2 years
- > Radio remote control : 2 years

The warranty is valid for two years as from the date of receipt.

### TERMS OF WARRANTY

- For the warranty to be valid, you have to provide the warranty sheet duly completed (point of sale stamp, date of purchase - salesperson's signature, serial number and year of manufacture) along with the invoice.
- The warranty only covers repairs involving replacing items which have proved to be defective after verification by AMR. The cost of spare parts is borne by AMR. Labour costs and travel expenses are borne by the dealer. Wearing parts (brass slide, cable, belt) are not covered by the warranty. The warranty does not take into account transport costs.
- For the safety of the user and the validity of the warranty, it is absolutely essential to use spare parts recommended by AMR (contact your dealer for more information).

The warranty is cancelled :

- If there have been attempts to carry out repairs not prescribed by the manufacturer,
- In the event of a defect resulting from poor maintenance or misuse by an unauthorised person.

### LEGALS

Subject to correction of misprints and composition as well as changes in prices and product developments .  
The product warranty is exclusive wear parts. References of use and recommended wood are indications and depend on the context and the materials used. Non-contractual photo.  
Responsible for content : AMR SAS - 1 rue de l'Industrie 67390 ELSENHEIM (FRANCE) - Tel: 03 88 58 69 69  
Fax: 03 88 58 69 70      info@a-m-r.fr      www.a-m-r.fr

# YOUR DEALER

## EXHIBITIONS

APR	07/04-09/04/17	FORST Live Offenburg (Germany)
MAY	08/05/17	AMR's open-days Elsenheim (France)
JUNE	7/06-10/06/17	Elmia Wood Sweden
JUNE	24/06-25/06/17	Les Cognées Les Gets (France)
JULY	29/07-01/08/17	Libramont fair Belgium
SEPT	20/09-21/09/17	SALON VERT Lyon (France)
OCT	05/10-07/10/17	Sommet de l'élevage Cournon (France)
OCT	21/10-22/10/2017	Poussay fair France

All exhibitions on [www.a-m-r.fr](http://www.a-m-r.fr)

# AMR

PUISSANCE & PERFORMANCES

AMR - 1 rue de l'Industrie - 67390 ELSENHEIM - FRANCE  
Tél. 03 88 58 69 69 - Fax 03 88 58 69 70 - [info@a-m-r.fr](mailto:info@a-m-r.fr) - [www.a-m-r.fr](http://www.a-m-r.fr)

